

Trend Synergy[®] Aluminium

Sliding Door

TECHNICAL DATA

Features & Benefits

Size Range

Ordering Details

Installation

Cross Sectional Views

Features & Benefits

Synergy® Sliding Door

1 Energy Efficiency Options

To reduce energy consumption, Thermashield® systems are available in various WERS ratings and glazing styles.

Thermashield® Double Glazing is available for energy efficiency requirements.

2 Acoustic Options

SoundMizer® acoustic solutions are available for sliding doors. SoundMizer® acoustic solutions can reduce aircraft, highway traffic, railway and other annoying noise problems. For information or technical details contact Trend®.

3 Locks

Sliding doors are fitted with standard black slimline lock or upgrade to “D” handle is optional.

4 Safety Glazing

Toughened Safety A Grade Glass with a visual motif at the mid point to provide added safety. Laminated Glass is used in all non standard door sizes. Glass sits into the extrusion door glazing pocket up to 13mm.

5 Protected Rolling Track

An extruded aluminium splayed threshold protects both glass door and flydoor rolling tracks.

6 Wheelchair Access

The aluminium threshold features the Easyrider™ sill which is ideal for wheelchair access.

7 Frames

Trend® Door frame is 101.6mm wide with standard lock. The sash has aesthetically pleasing lines and a smooth rounded profile that has a truly solid look.

Maximum Door Height is 2400mm
Maximum Panel Width is 1500mm
Maximum Door Width is 6010mm

7 Interlockers

Three types of interlockers are available depending on the structural pascal ratings. Trend® Sliding Door ultimate structural rating is 1500 pascals (kPa).

9 Screen Door

An external extruded aluminium sliding screen door can be fitted with spring loaded acetal wheels. Ensuring the screen door stays on the track and operates smoothly. Optional heavy duty barrier door is available.

10 Complementary Accessories

- 180° non-load-bearing couplers
- 135° non-load-bearing corner couplers.
- 100mm aluminium architraves for replacement door installations.
- Adjustable aluminium storm mould.
- Extruded aluminium 180° mullion covers to hide load-bearing posts.

11 Options

Colonial Bar, Federation Bar Layouts and Ovolo adaptor are available.

Easy to fit flyscreens.

Wide range of powdercoat finishes including Timber finishes are available. This product rates up to BAL-29 for bushfire areas.

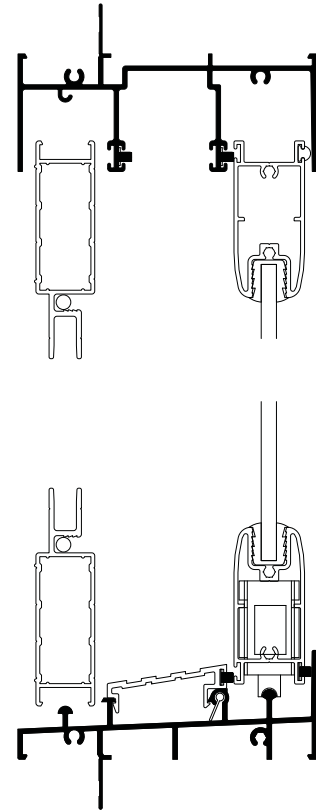

Size Range

Synergy® Sliding Door

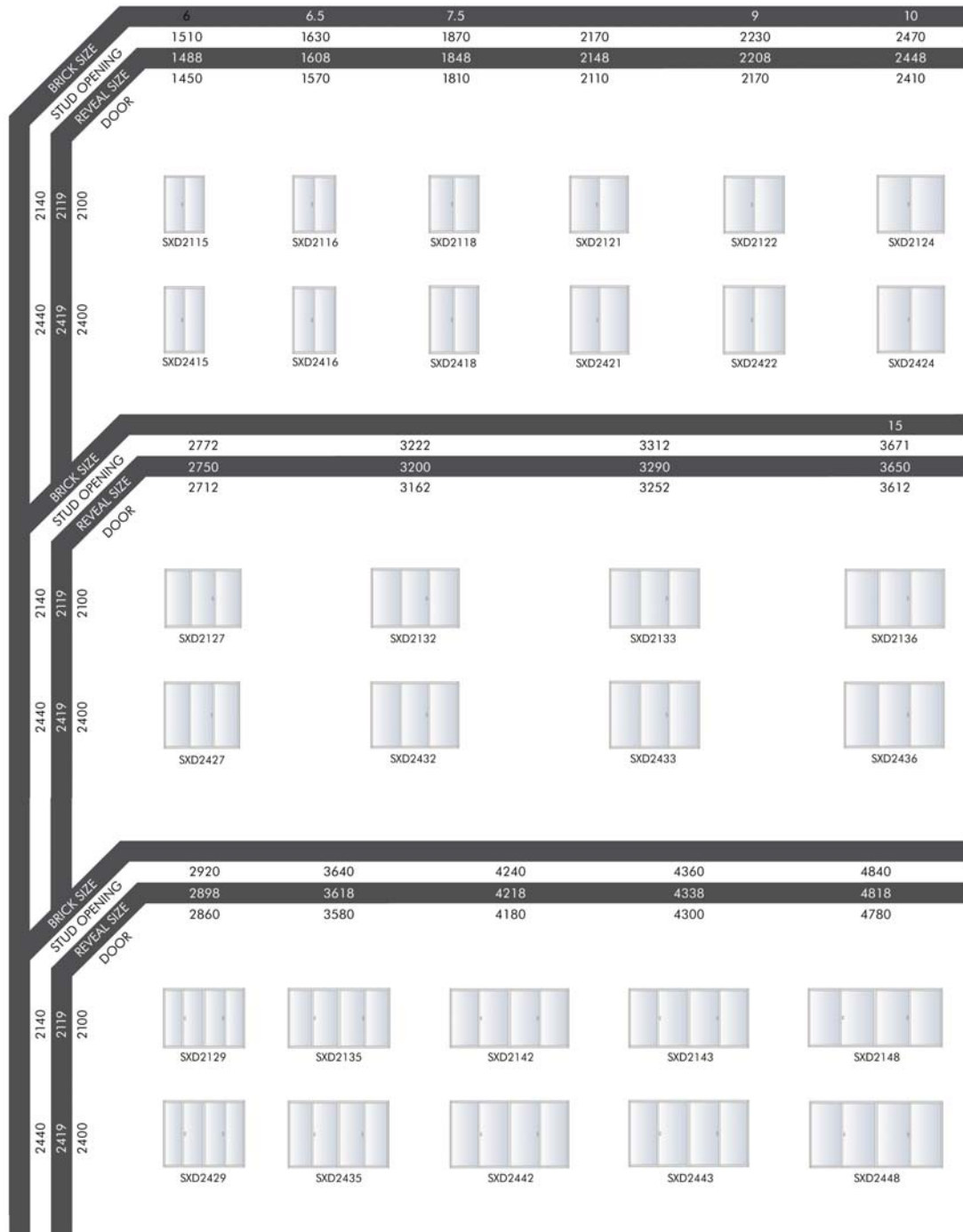

All windows and doors are designed to 700pa velocity and 150pa water rating. For higher ratings consult Trend® Windows & Doors

** Refers to 2400mm frame height

Please note that drawings are not to scale

Synergy® Sliding Door | TXD | Mk-7 | 3 July 2013

Confidentiality Notice: This document and the information it contains are copyright and confidential to Trend® Windows & Doors Pty Limited. Disclosure, use and copying in any form whatsoever, except as authorised by Trend® Windows & Doors in writing, are strictly prohibited. Patents and Design Registrations pending.

Ordering Details

Synergy® Sliding Door

All doors are illustrated as viewed from outside. Codes shown are for plain doors. The first two numbers of code indicate approximate height, the last two numbers indicate approximate width.

Sash Style Options:

Standard option, eg door code SXD2018

O indicates ovolo sash style, eg door code TOXD2018

CL indicates colonial bar

T indicates Thermashield® double glazed sash style, eg door code STXD2018

M indicates Acoustic sash style (SoundMizer®), eg door code SMXD2018

S indicates Sump Sill, eg door code SSXD2018

Bar Options:

CL indicates Colonial Bar, eg door code TXD2018CL

FD indicates Federation Bar, eg door code TXD2018FD

Configuration Options:

XF indicates Sliding/Fixed

FX indicates Fixed/Sliding

FXF indicates Fixed/Sliding/Fixed

FXXF indicates Fixed/Sliding/Sliding/

Fixed

This product rates up to BAL-29 for bushfire areas

Hardware Options:

Black slimline hardware is supplied as standard or upgrade to “D” lock style.

Optional colours available is anodic natural matt, stone beige, pearl white or satin chrome.

General:

Two and Three panels doors available as reverse to brochure

Four panel doors have a prefix of TXXD

Low profile sill supplied as standard

The sill must be level side to side and front to back and fully supported during and after construction.

The aluminium sill and external brick skin must be separated with an isolator to prevent possible reaction between brick and mortar and the aluminium frame which can lead to crevice corrosion.

NOTE: Synergy® Sliding Door are not available in Victoria they supply Quantum Sliding Door.

Installation

Synergy® Sliding Door | Building In Detail | **Brick Veneer - 230mm wall**

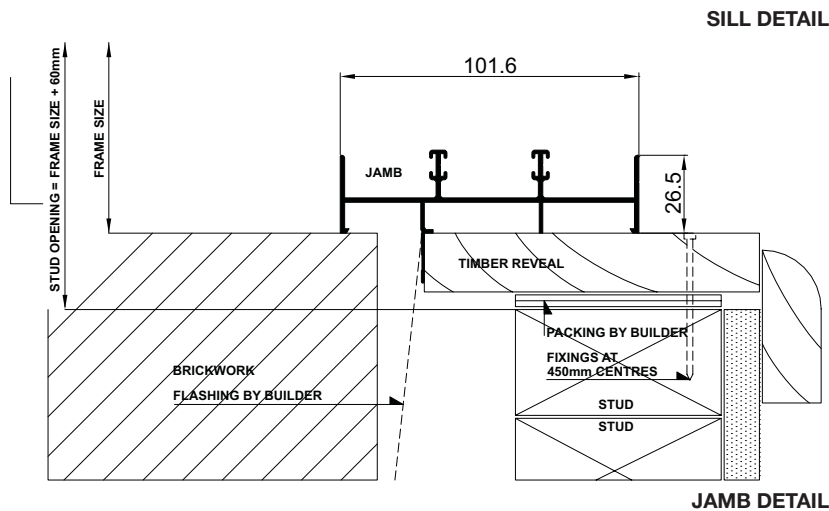
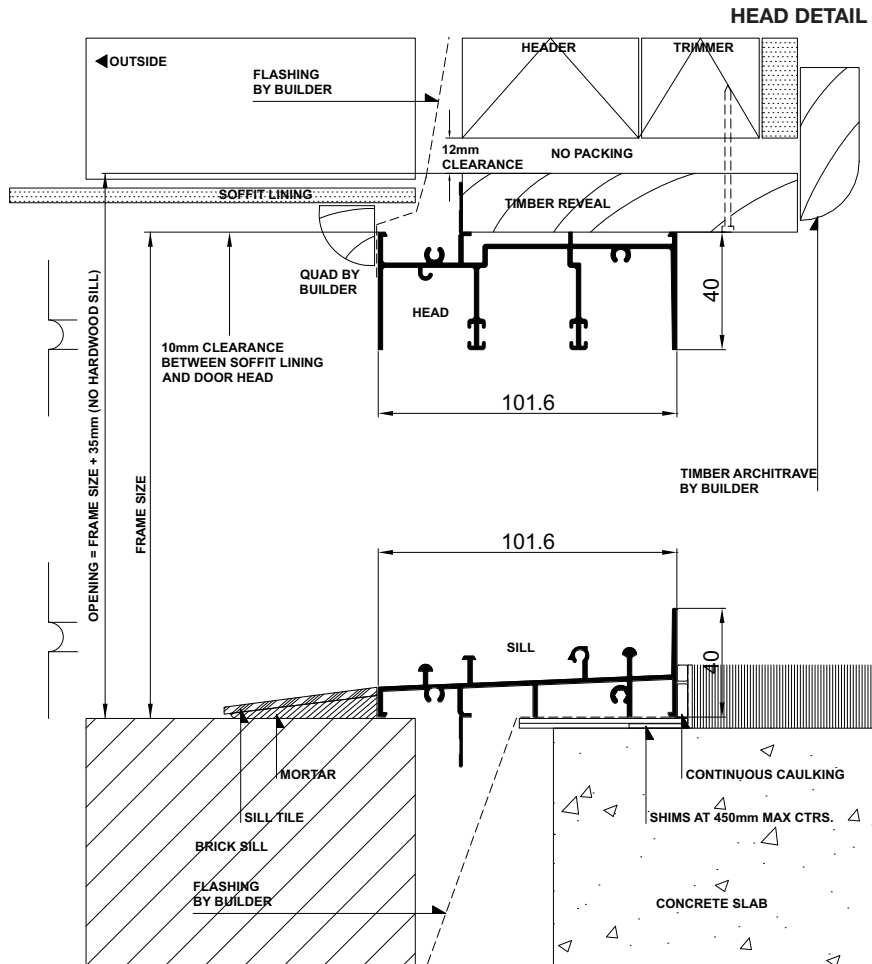

Installation

Synergy® Sliding Door | Building In Detail | **Double Brick - 280mm wall**

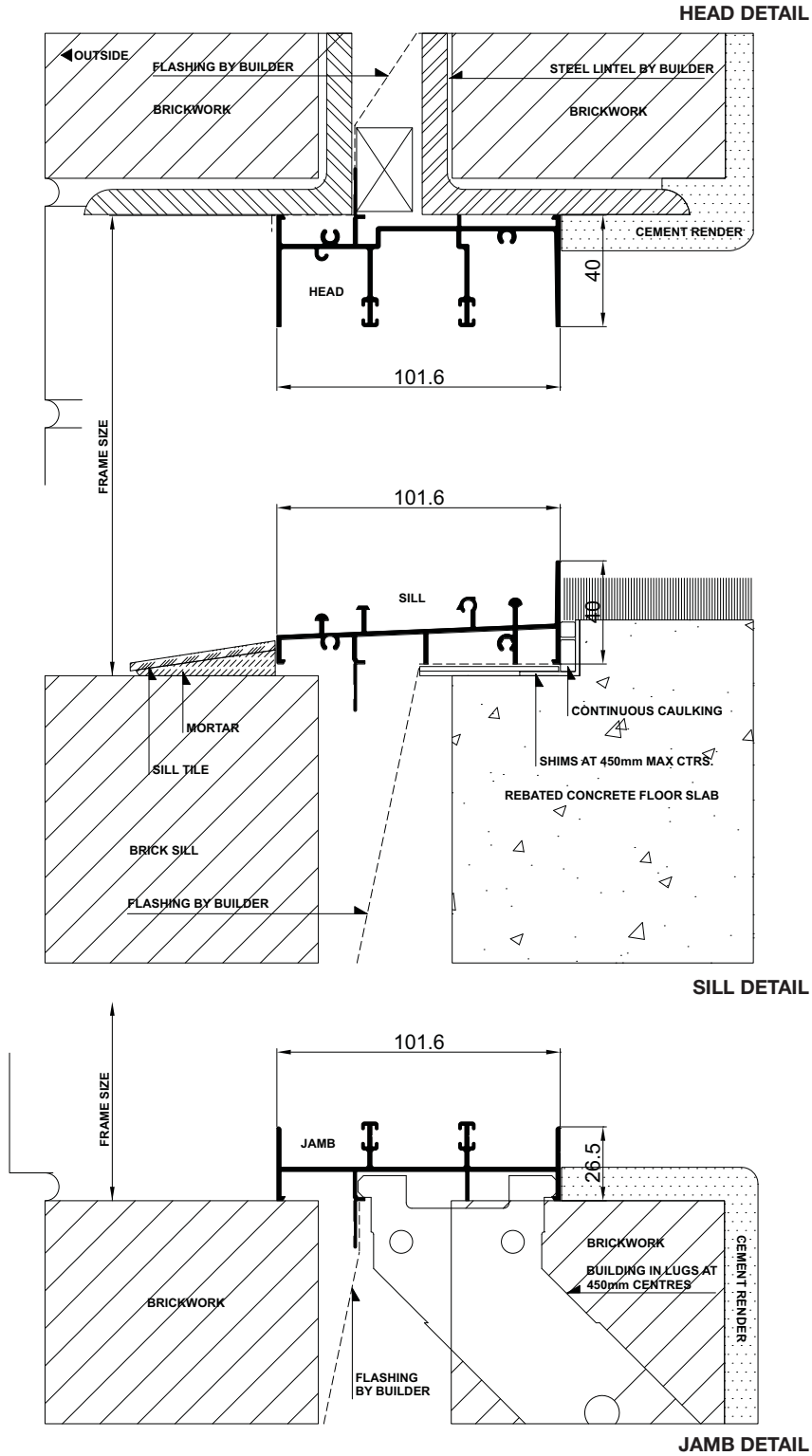

Installation

Synergy® Sliding Door | Building In Detail | Aluminium Cladding on Studs

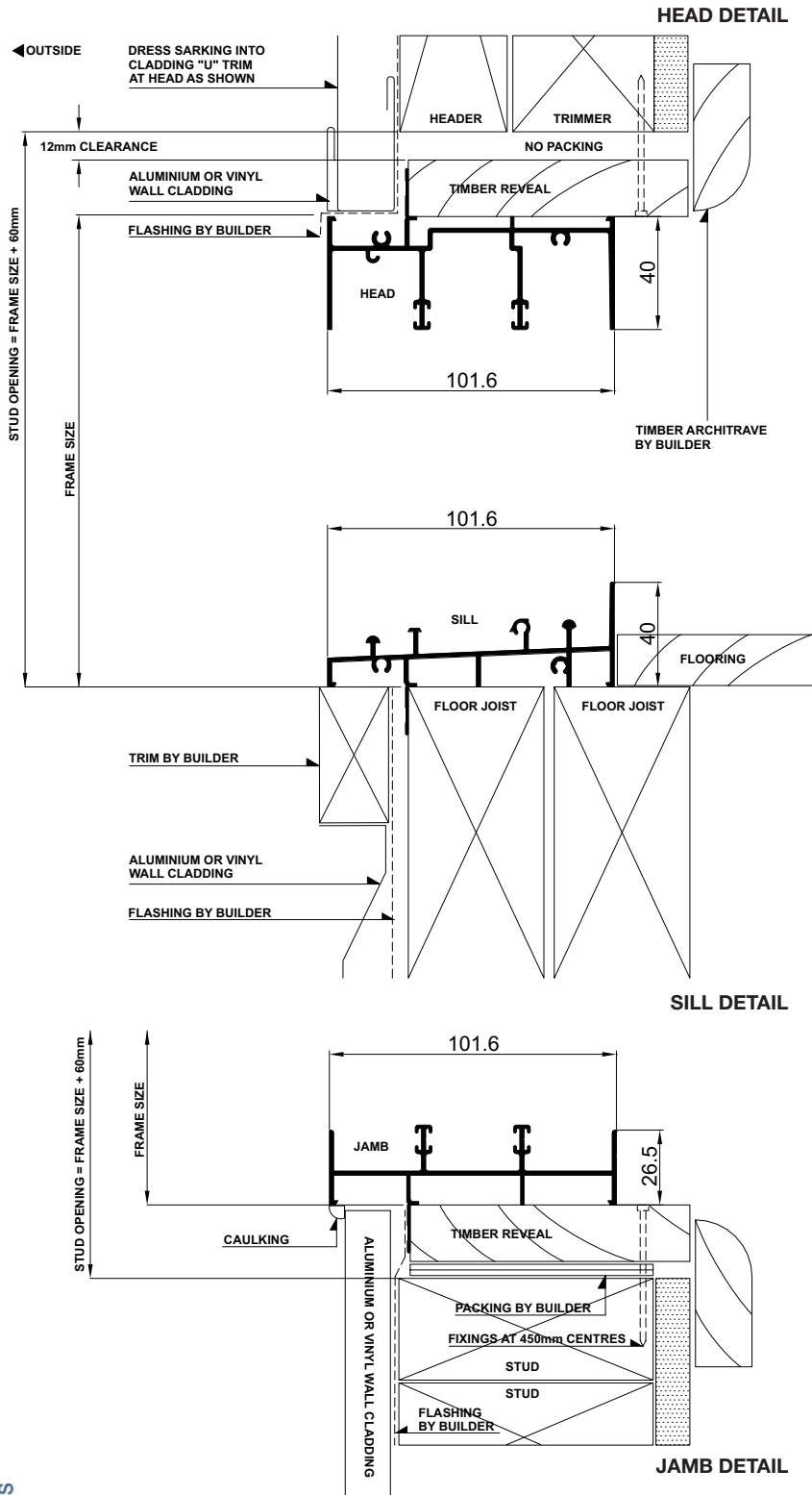

Cross Sectional Views

Trend® Sliding Door | Two Lite (FX)

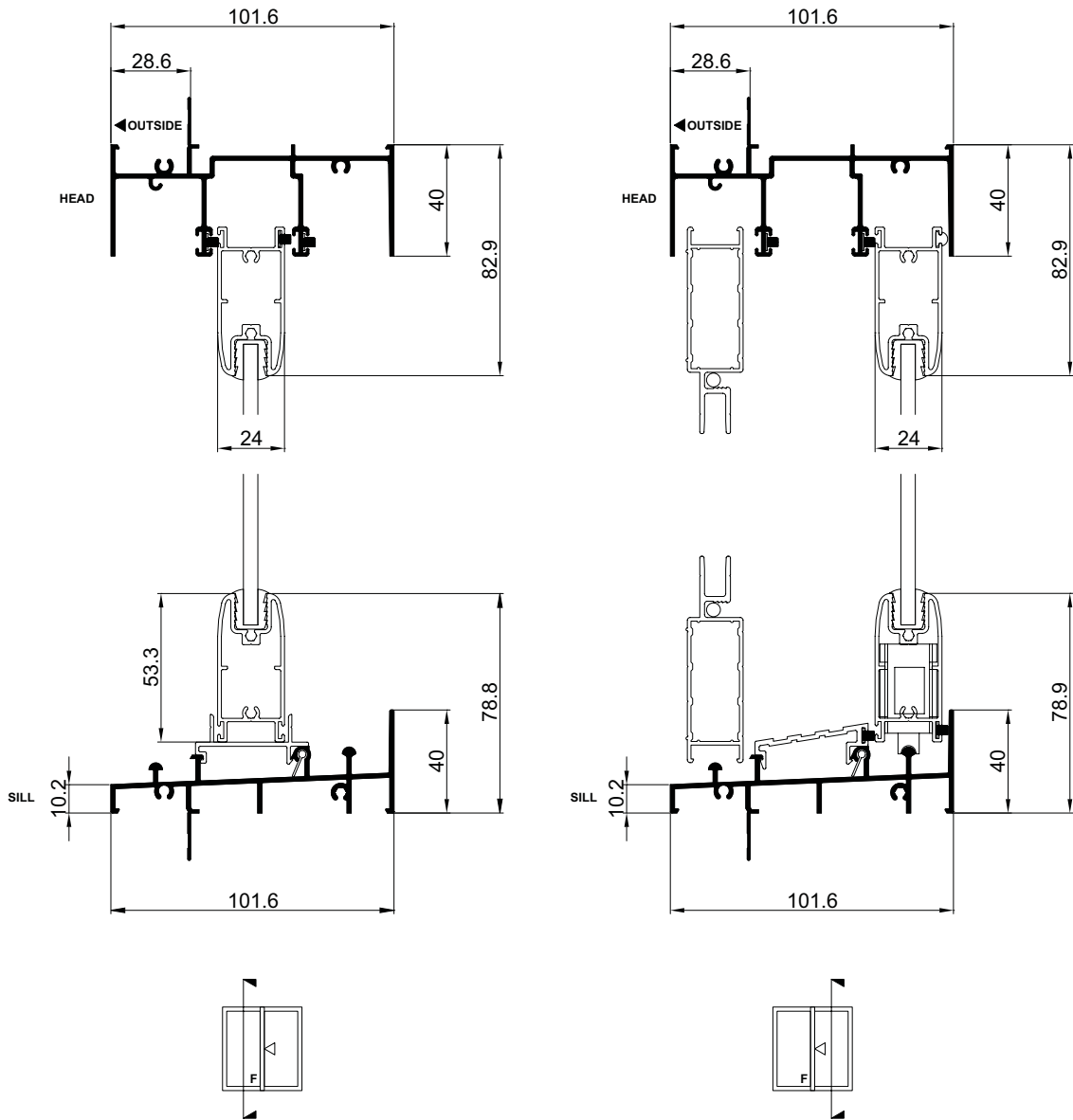

Cross Sectional Views

Trend® Sliding Door | Two Lite (FX)

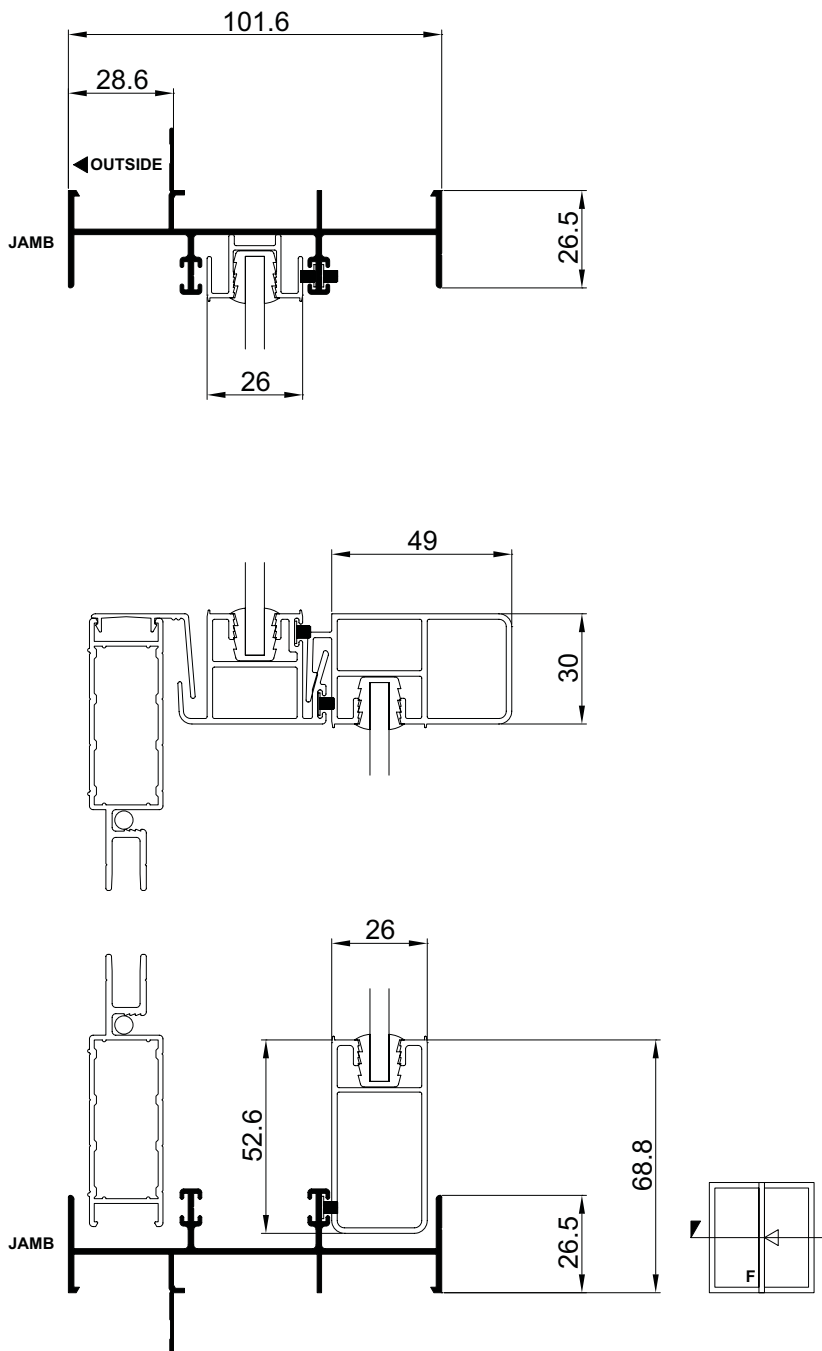

Cross Sectional Views

Trend® Sliding Door | **Three Lite (FXF)**

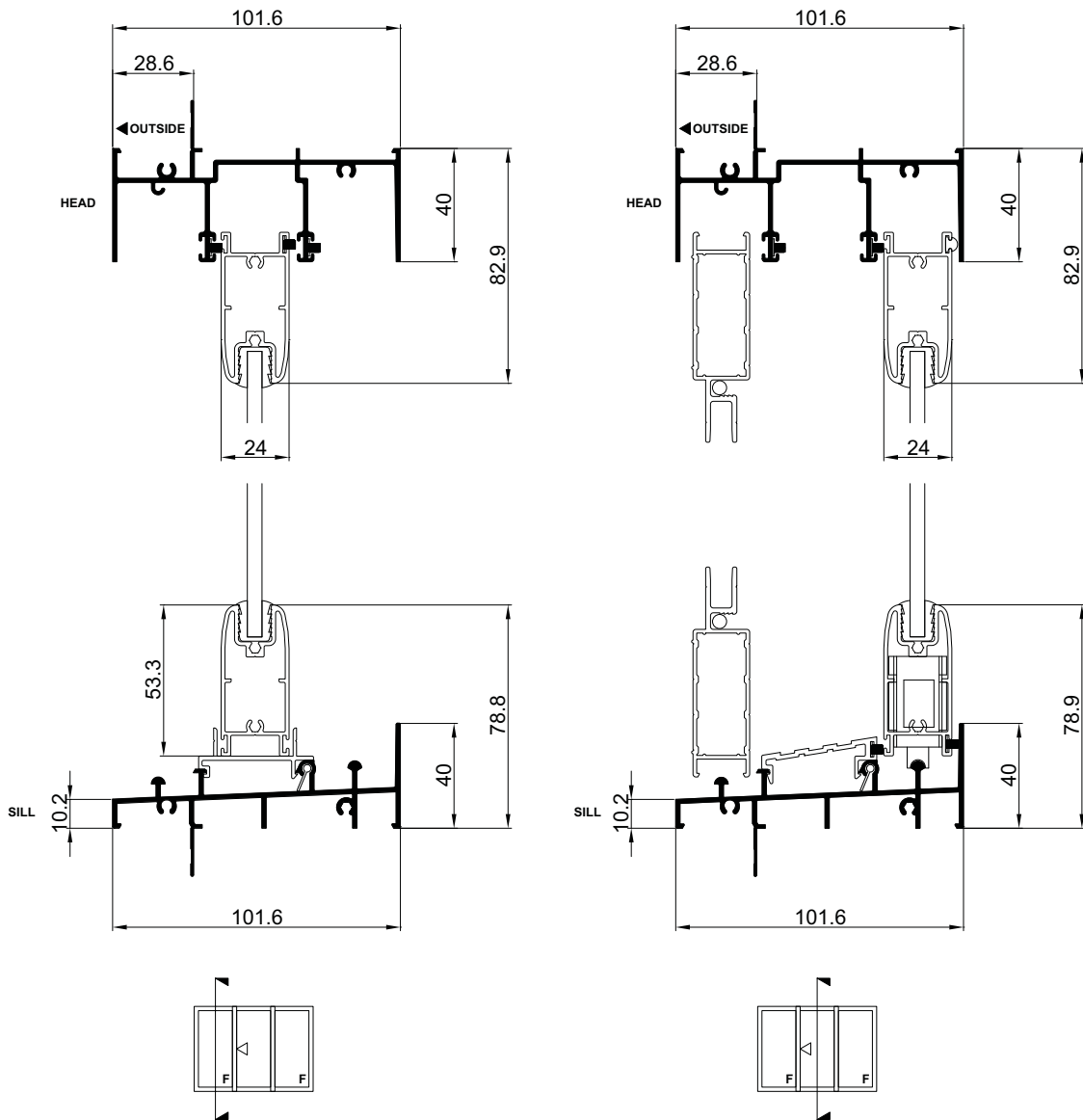

Cross Sectional Views

Trend® Sliding Door | **Three Lite (FXF)**

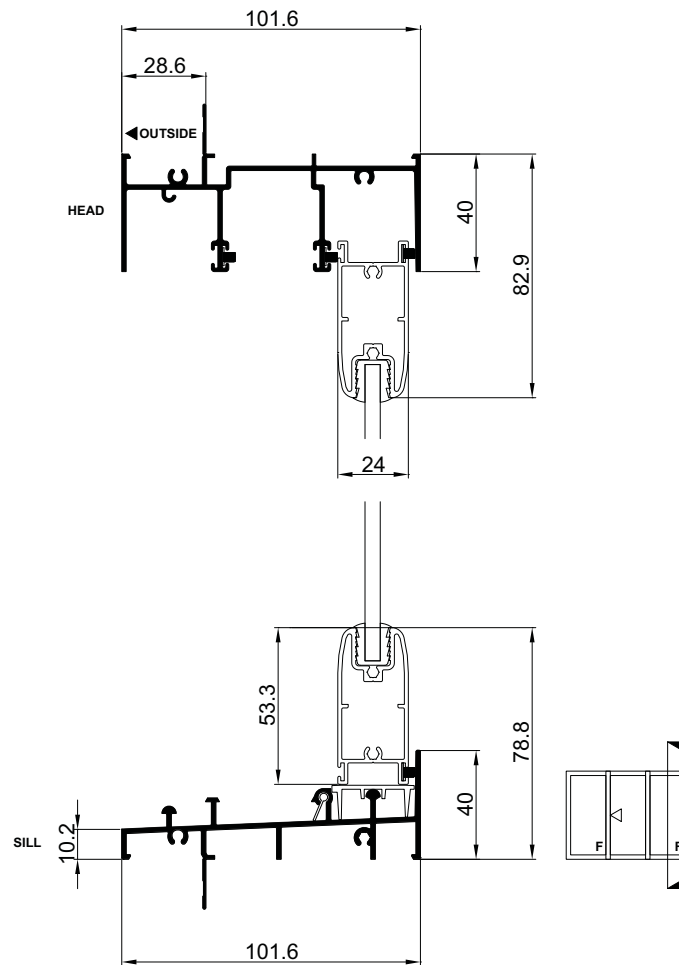

Cross Sectional Views

Trend® Sliding Door | **Three Lite (FXF)**

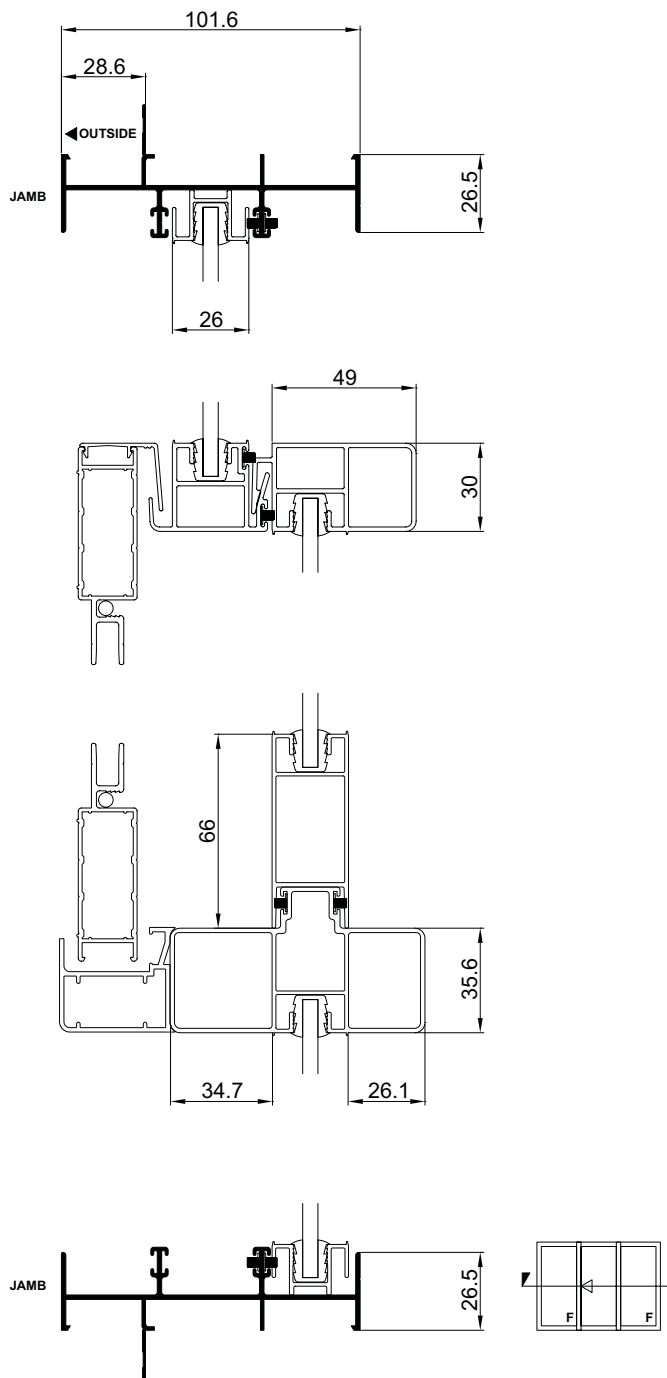

Cross Sectional Views

Trend® Sliding Door | **Four Lite (FXXF)**

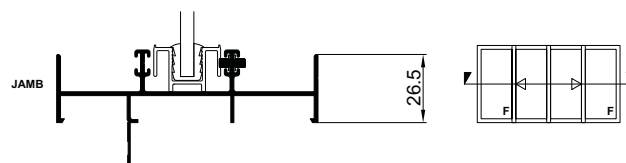
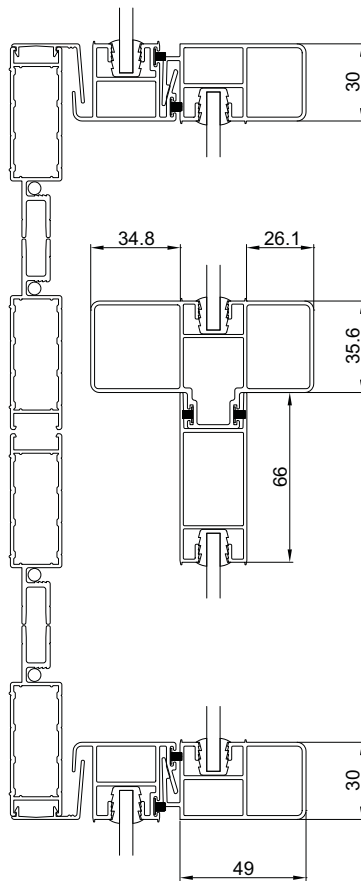
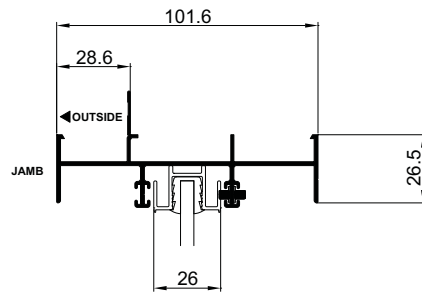

Cross Sectional Views

Trend® Sliding Door | 2x2 Internal Corner

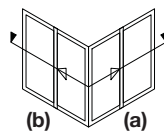
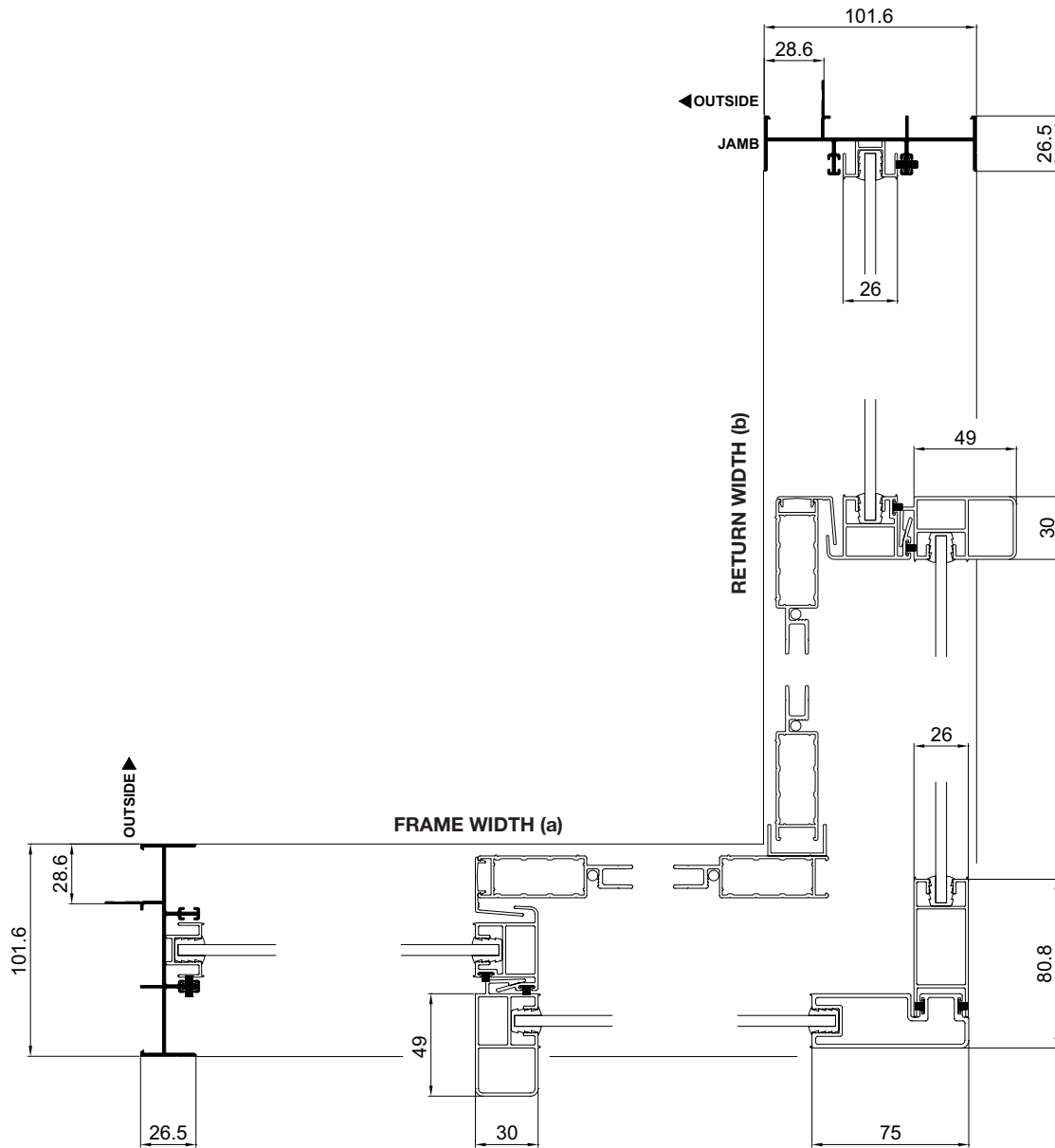

Cross Sectional Views

Trend® Sliding Door | 2x2 External Corner

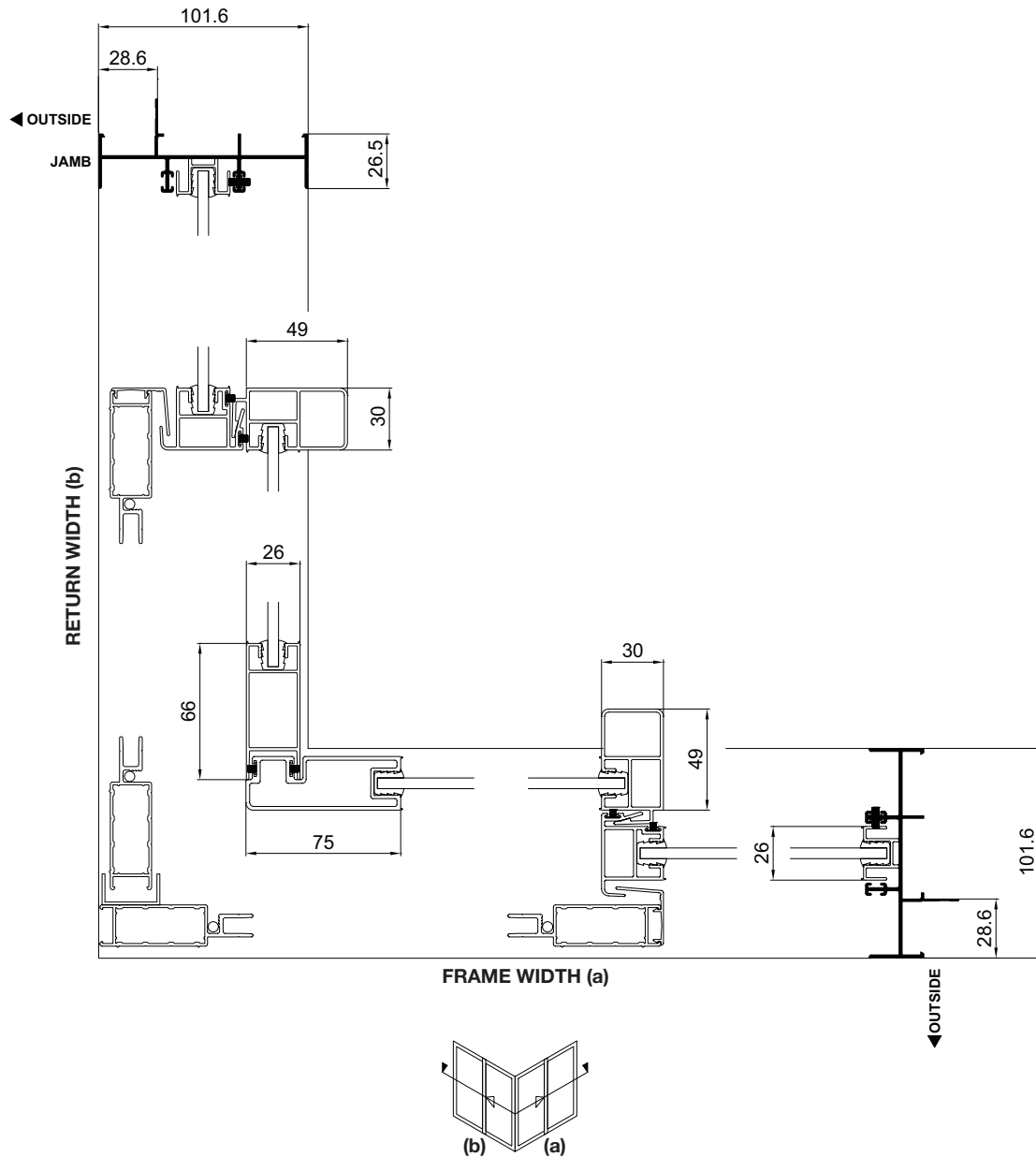

Cross Sectional Views

Trend® Sliding Door | Double Glazed

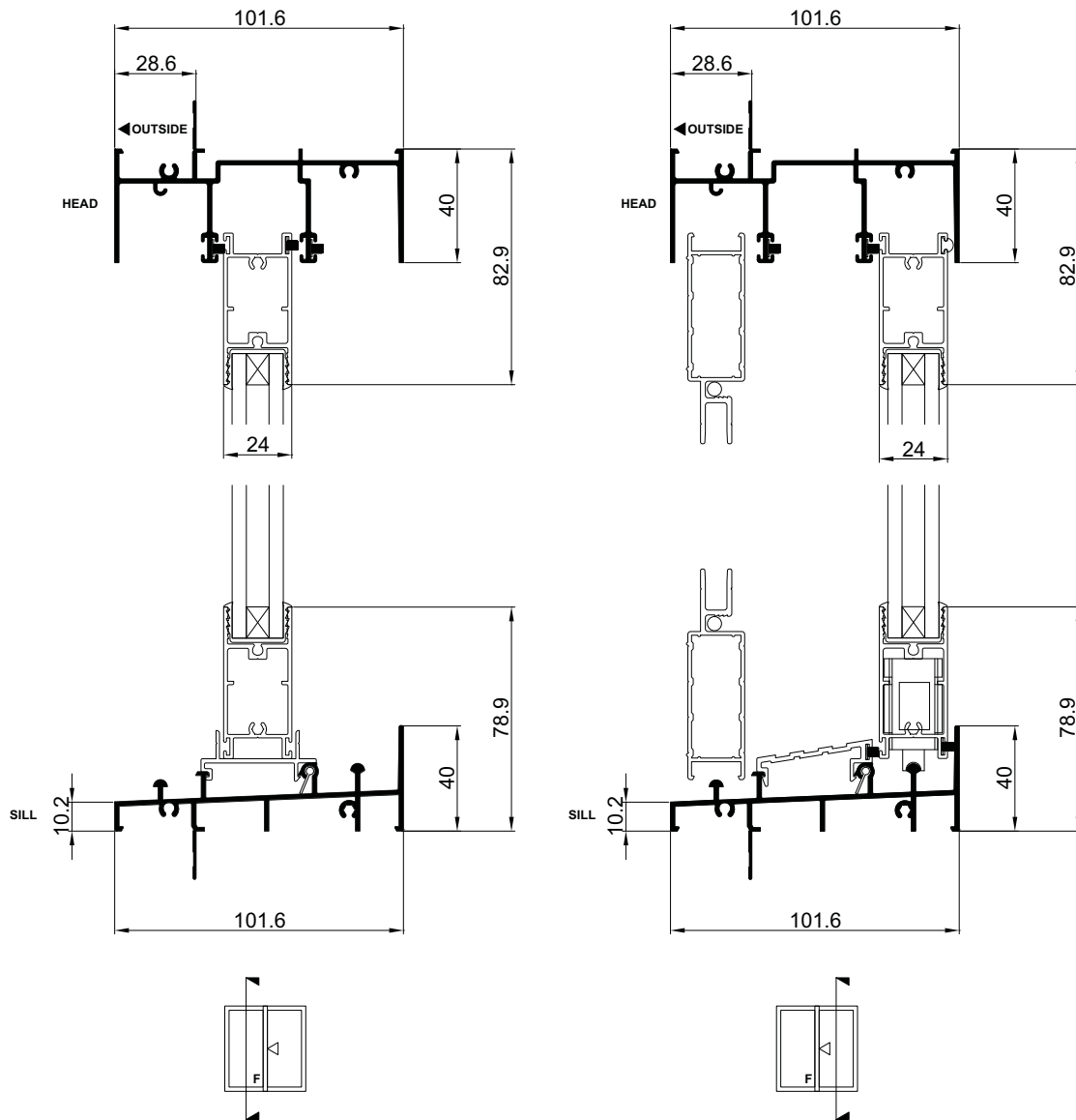

Cross Sectional Views

Trend® Sliding Door | **Double Glazed**

