

Trend Synergy<sup>®</sup> Aluminium

---

# Standard Double Hung

## TECHNICAL DATA

Features & Benefits

Size Range

Ordering Details

Installation

Cross Sectional Views

## Features & Benefits

### Synergy® Standard Double Hung

- 1 Energy Efficiency Options  
To reduce energy consumption, Thermashield® systems are available in various WERS ratings and glazing styles.
  - 2 Acoustic Options  
SoundMizer® acoustic solutions are available for double hung windows. SoundMizer® acoustic solutions can reduce aircraft, highway traffic, railway and other annoying noise problems. For information or technical details contact Trend®.
  - 3 Lock hardware  
Black is supplied as standard. Optional colours are anodic natural matt, stone beige, pearl white and satin chrome.
  - 4 Key locks  
All Trend® Standard Double Hung Windows are available with standard key lock that can be keyed to match other Trend® aluminium windows. Vent locks are available for Trend® Double Hung Windows.
  - 5 Interlocking Meeting Rails  
The interlocking meeting rails on the sashes combine together when closed to improve the overall weather performance strength. The sashes by-pass to facilitate easy internal glass cleaning.
  - 6 Weather sealed for full protection  
All sashes are fitted with weatherpile seals to keep the dust and water where they belong, on the outside.
  - 7 Complementary Accessories
    - 180° non-load bearing couplers, two types available for added mullion strength when required.
    - 135° & 90° non-load-bearing corner couplers to suit bay and kitchen windows.
    - 100mm aluminium architraves for replacement window installations.
    - Adjustable aluminium storm mould.
    - Aluminium 180° and 90° mullion covers to hide load-bearing posts.
  - 8 Options  
Glue on Bar Layouts are available. Easy to fit flyscreens. Wide range of powdercoat finishes. For bushfire areas this product rates up to BAL-29
- \*Double glazing is not available with the Standard or Designer double hung

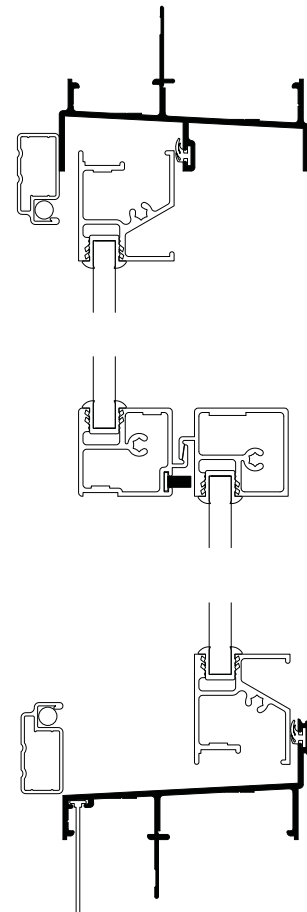

# Size Range

Synergy® Standard Double Hung

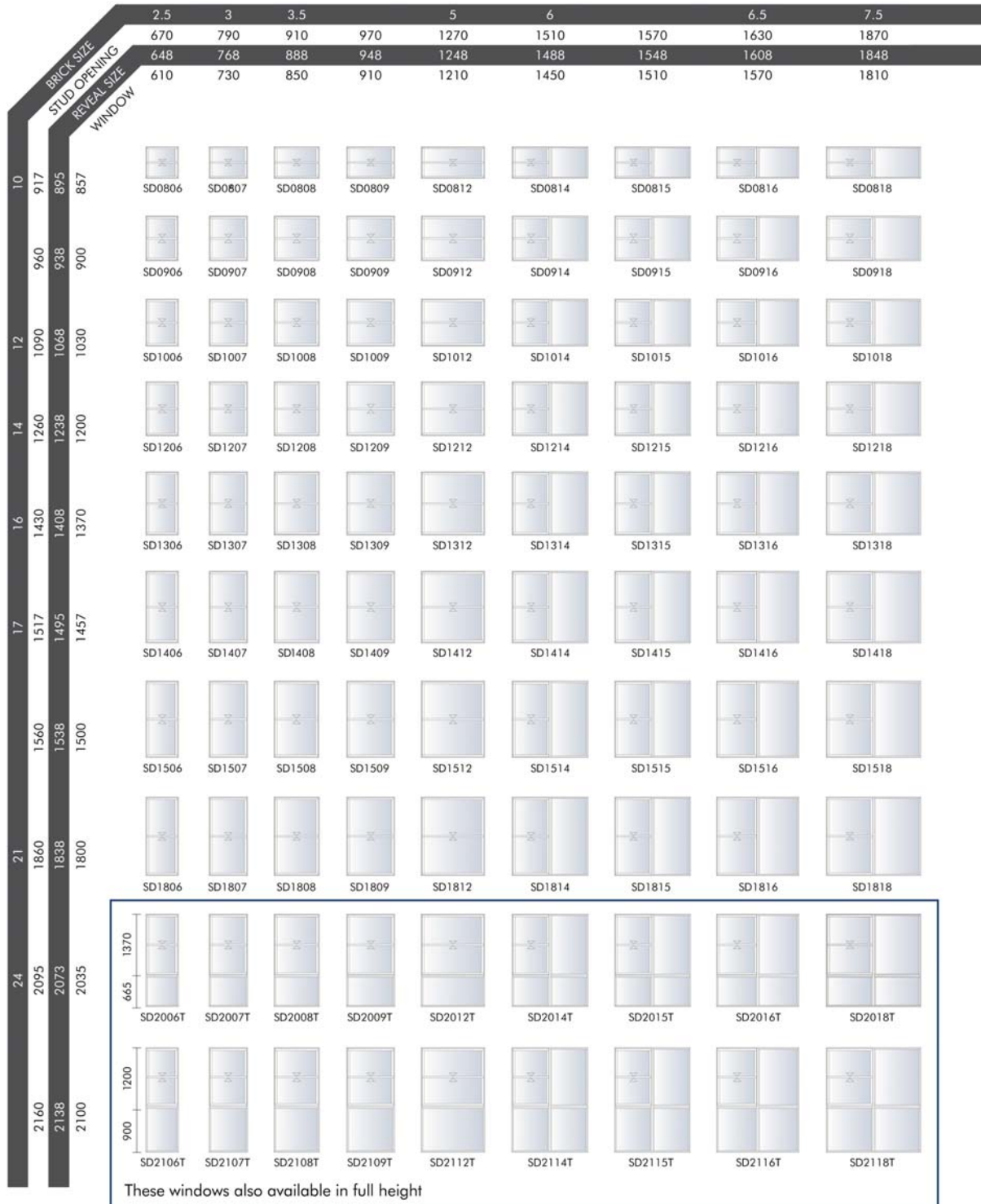

# Size Range

Synergy® Standard Double Hung

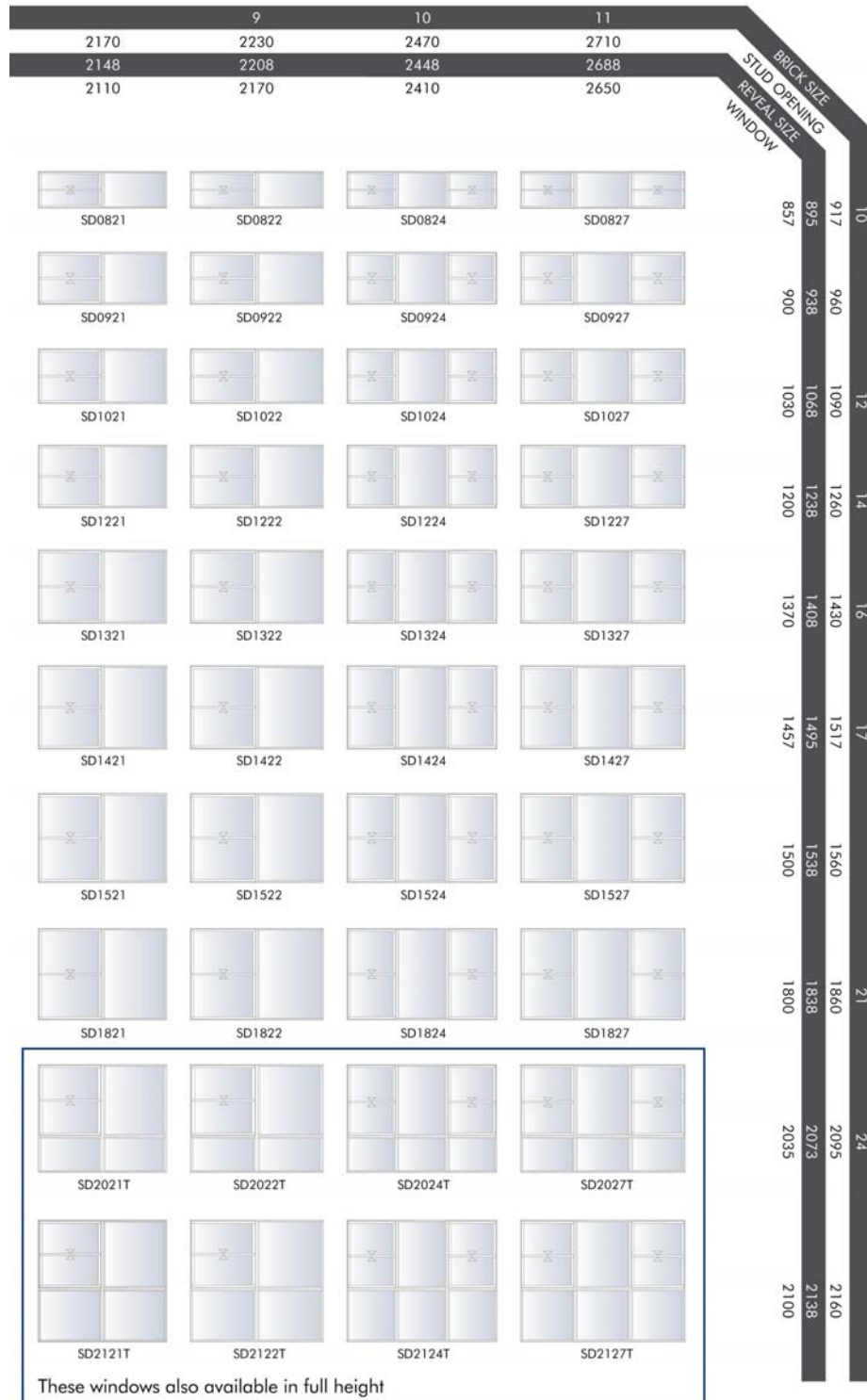

All windows and doors are designed to 700pa velocity and 150pa water rating. For higher ratings consult Trend® Windows & Doors

Please note that drawings are not to scale

Synergy® Standard Double Hung | ATD | Mk-7 | 4 July 2013

Confidentiality Notice: This document and the information it contains are copyright and confidential to Trend® Windows & Doors Pty Limited. Disclosure, use and copying in any form whatsoever, except as authorised by Trend® Windows & Doors in writing, are strictly prohibited. Patents and Design Registrations pending.



## Ordering Details

Synergy® Standard Double Hung

All windows are illustrated as viewed from outside. Codes shown are for plain windows.

Manufactured from 64mm aluminium extrusion. The first two numbers of code indicate approximate height, the last two numbers indicate approximate width.

### **Sash Style Options:**

Standard option, eg window code ATD0906

M indicates Acoustic sash style (SoundMizer)

### **Bar Options:**

CL indicates Colonial Bar, eg window code ATD0906CL

FED indicates Federation Bar, eg window code ATD0906FED

### **Configuration Options:**

DF indicates Double Hung/Fixed

FD indicates Fixed/Double Hung

DD indicates Double Hung/Double Hung

DFD indicates Double Hung/Fixed/Double Hung

DDD indicates Double Hung/Double Hung/Double Hung

F indicates Fixed

T after the size indicates a Transom

### **General:**

Black hardware is supplied as standard. Optional colours are anodic natural matt, stone beige, pearl white and satin chrome.

# Installation

Synergy® Standard Double Hung | Building In Detail | **Brick Veneer - 230mm wall**

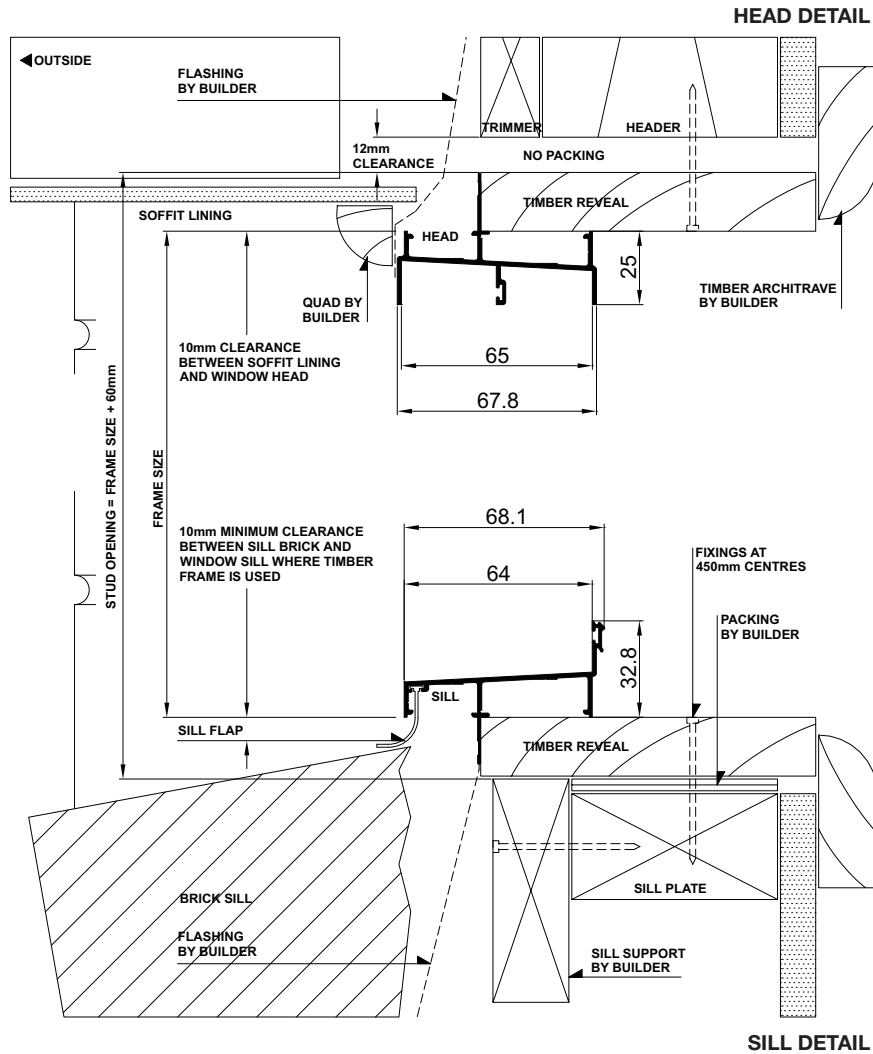

**SILL DETAIL**

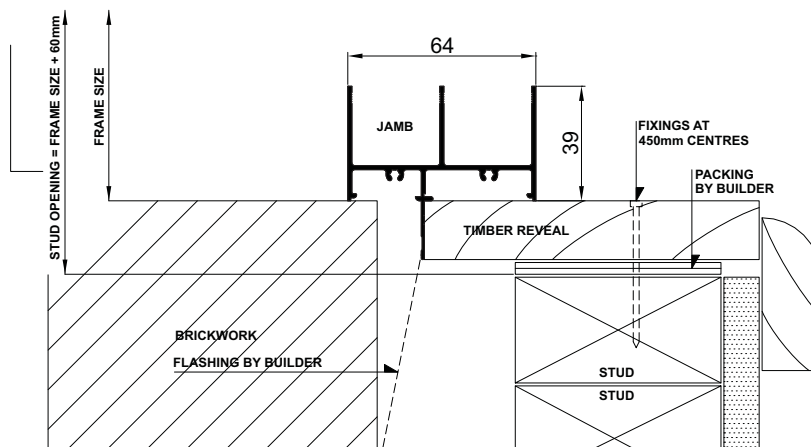

**JAMB DETAIL**

# Installation

Synergy® Standard Double Hung | Building In Detail | **Double Brick - 280mm wall**

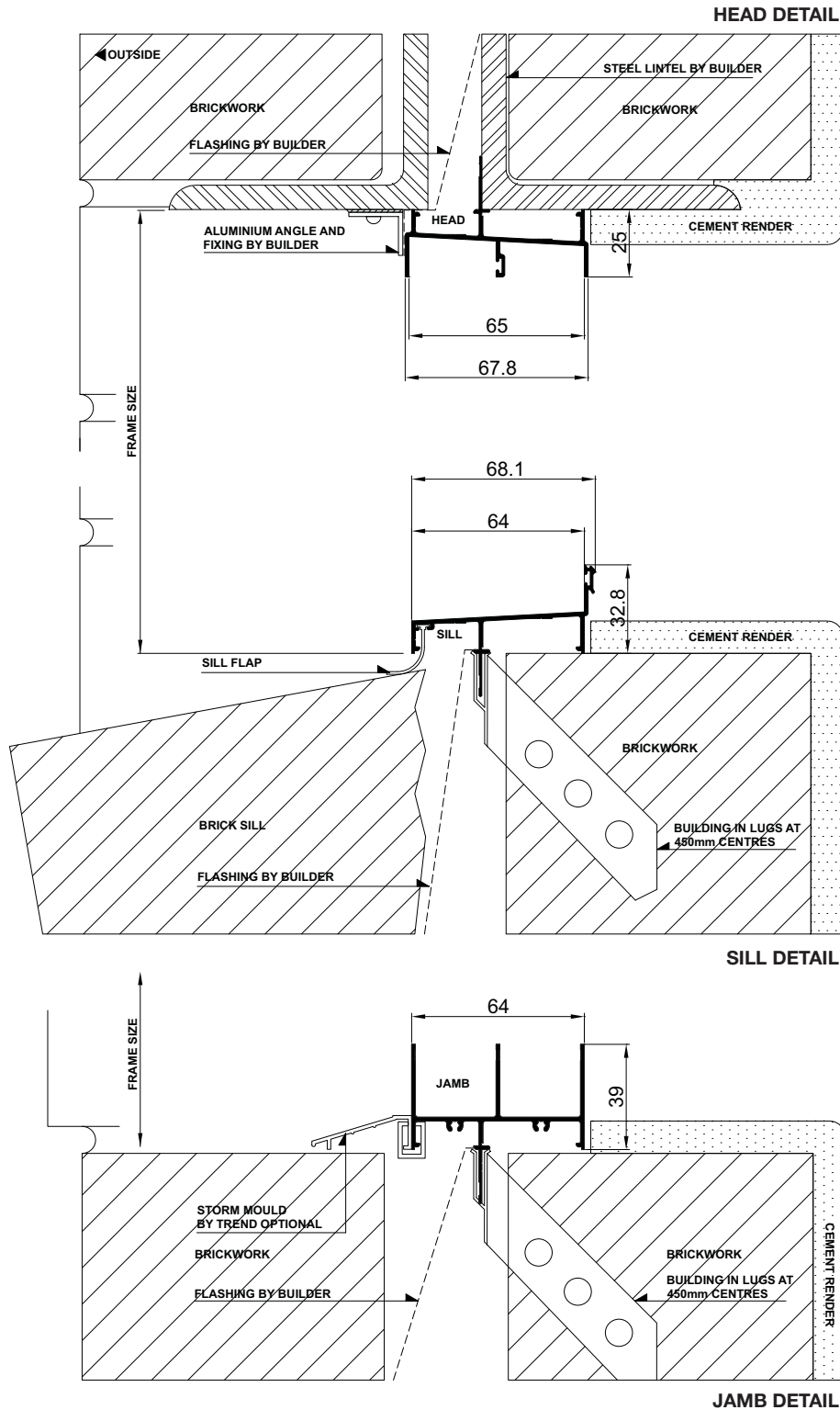

# Installation

Synergy® Standard Double Hung | Building In Detail | Aluminium Cladding on Studs

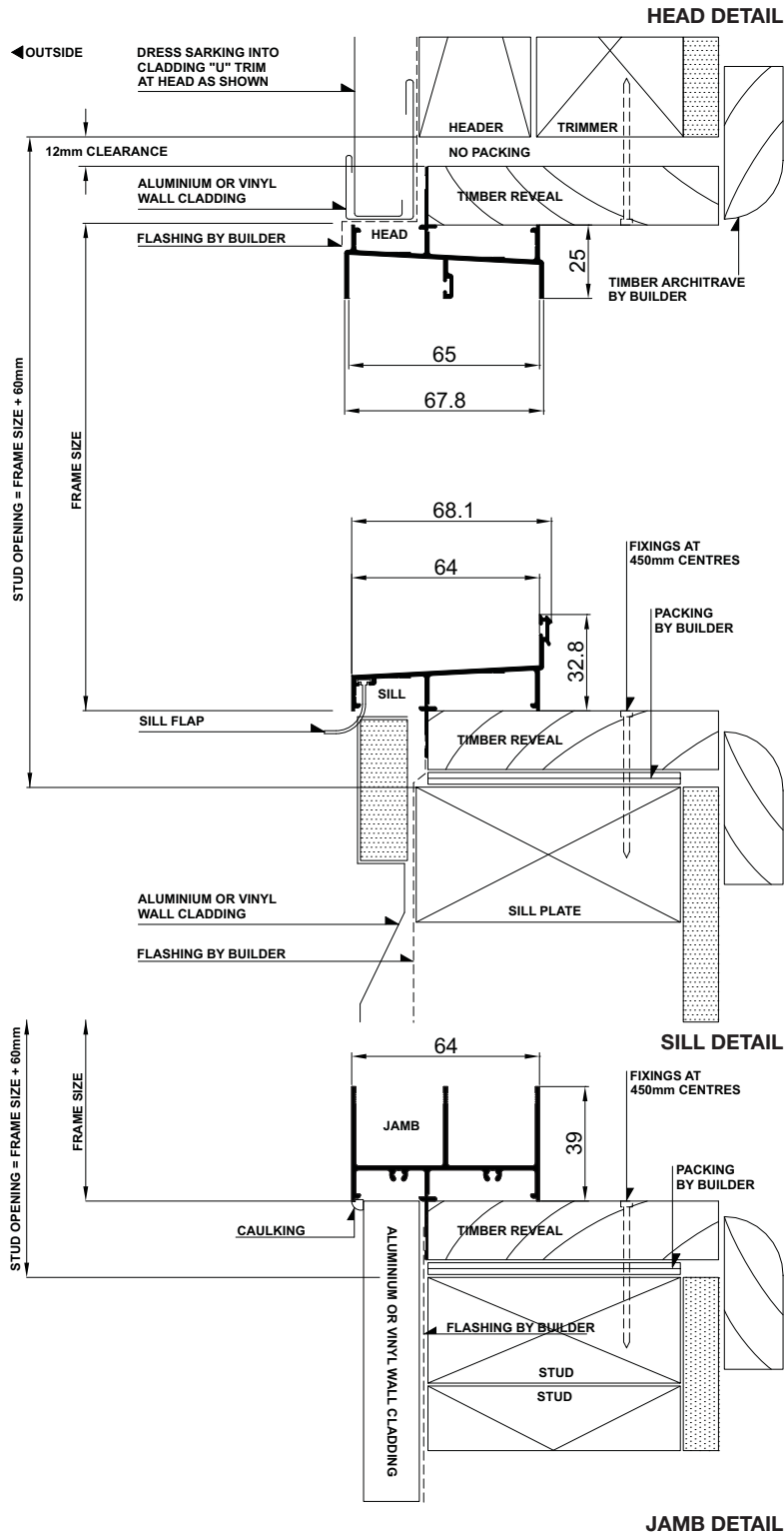



# Cross Sectional Views

Synergy® Standard Double Hung | **Single Lite**

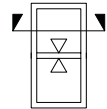
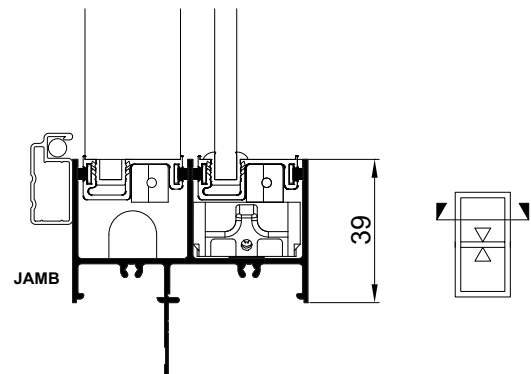
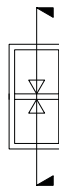
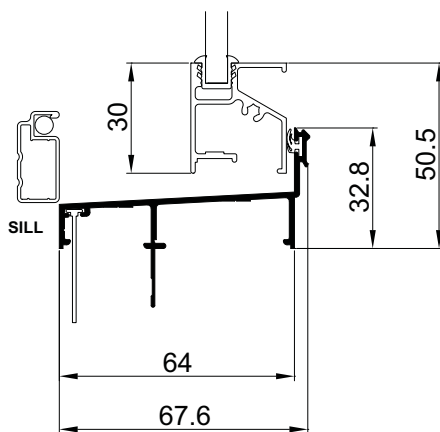
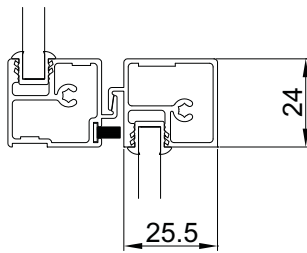
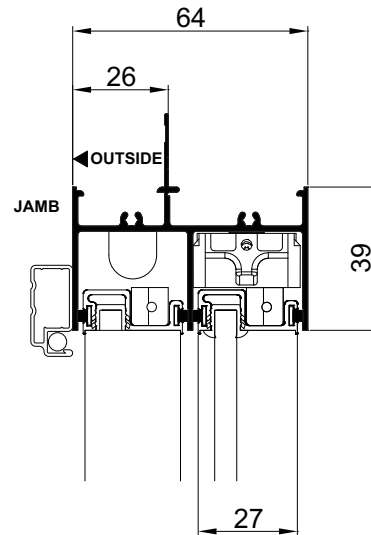
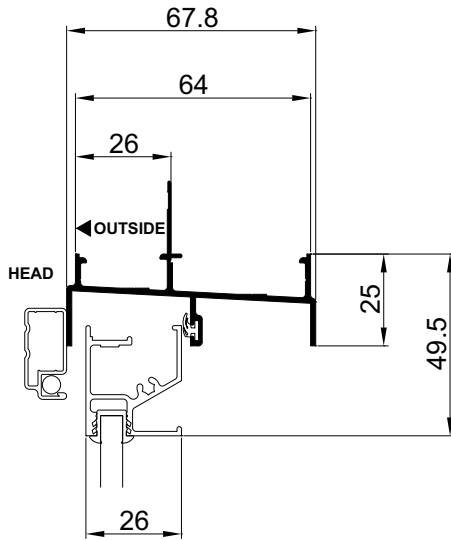

# Cross Sectional Views

Synergy® Standard Double Hung | Two Lite with Lowlite

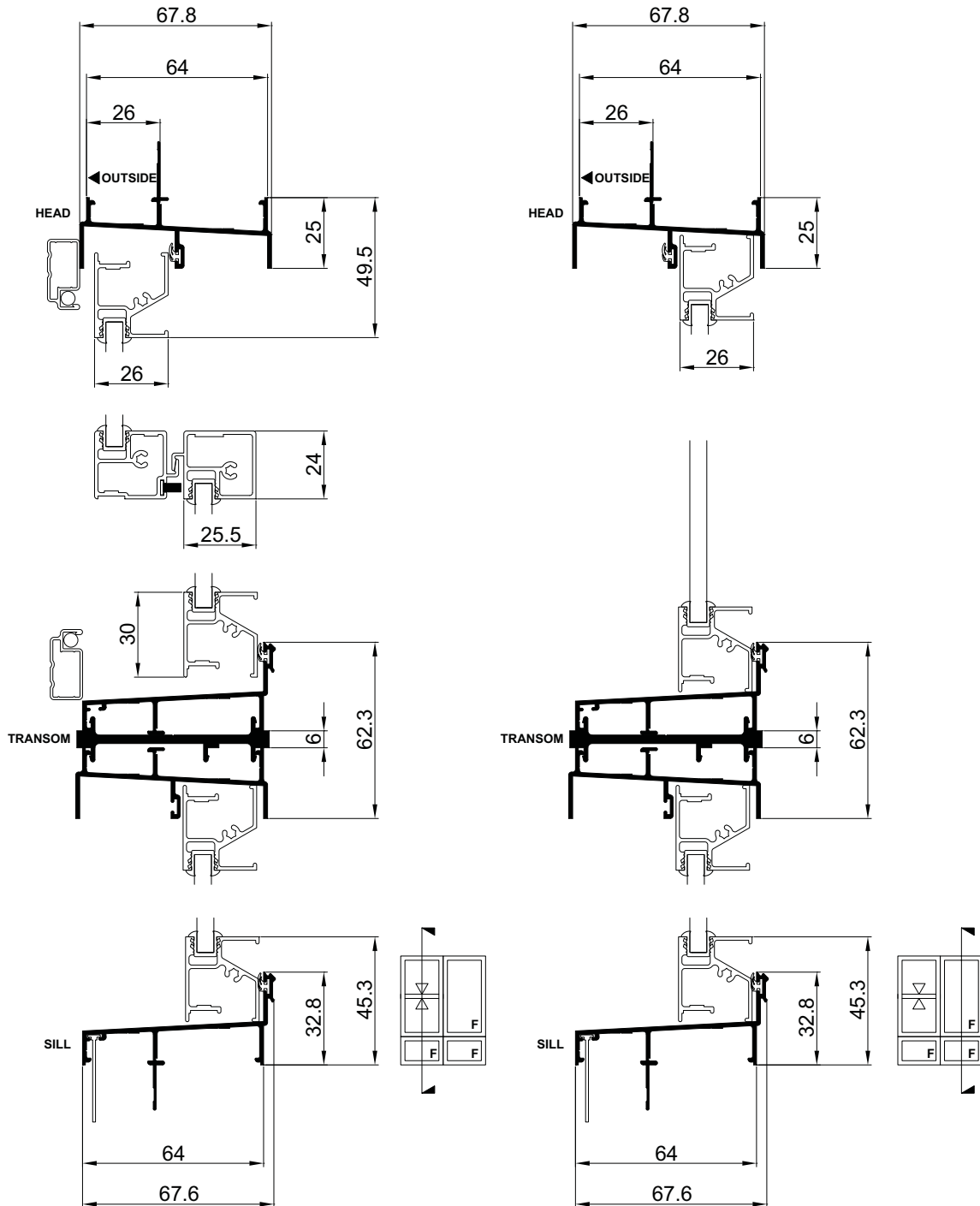

# Cross Sectional Views

Synergy® Standard Double Hung | **Two Lite with Lowlite**

