

Xtreme[®] Trend Aluminium

Awning 48mm/Sentinel

TECHNICAL DATA

Features & Benefits

Size Range

Ordering Details

Installation

Cross Sectional Views

Please note that drawings are not to scale

Xtreme[®] Awning | AAE | Mk 1 | 30 August 2011

Confidentiality Notice: This document and the information it contains are copyright and confidential to Trend[®] Windows & Doors Pty Limited. Disclosure, use and copying in any form whatsoever, except as authorised by Trend[®] Windows & Doors in writing, are strictly prohibited. Patents and Design Registrations pending.

Features & Benefits

Xtreme® Aluminium Awning

- 1 **Energy Efficiency Options**
Trend® Thermashield® in various glazing styles are available to help reduce energy consumption. Trend® Thermashield® means greater control, bigger savings and most importantly one less thing to worry about. Energy efficient options to u-value of 3.5 and SHGC 0.39 are available for Trend.
- 2 **Acoustic options**
SoundMizer® acoustic solutions in various STC ratings, are available to STC 39 for Trend® Awning Windows. SoundMizer® acoustic solutions can reduce aircraft, highway traffic, railway and other annoying noise problems. For information or technical details contact Trend®.
- 3 **Optional Key Lock Chain Winder**
Trend® Awning Window winder mechanism is designed specifically for high performance, security and reliability. With a Polesium™ cover and base combined with a stainless steel chain as standard for long life and reliability, the winder can be used in even the harshest environment without the worry of corrosion. The robust mechanisms are mounted securely to the window with a concealed 2 point fixing. Keyed lock is standard for added security
- 4 **Continuous Hinge Hood**
The sash is protected from the weather by a continuous hinge hood that supports the sash and keeps the rain where it belongs - on the outside

- 5 **Weather Protection**
The tubular splayed sash, with self-draining trough, assist the coninuous surround bublb seal to protect against even the most adverse weather conditions
- 6 **Sash Corner Protection**
The bottom rail sash corners are protected by a custom nylon cover that acts as a sash guide into the frame
- 7 **Glazing**
Trend® sash is available in special toughened glass options with energy efficiency applications. Acoustic solutions are also available to high STC rating

(This may vary however. For more information on variations to this please contact you Trend Sales Executive)
- 8 **Bushfire Standards**
Complies with AS3959 and AS1530.8.1.

NOTE:
Window Placement - Care should be taken with locating opening awning windows in pedestrian traffic areas.

*Xtreme® Windows & Doors have been tested to AS1530.8.1, and comply to Section 8 Construction Service Bushfire Attack Level 40 (BAL-40), Radiant Heat Level 40kW/m², AS3959 (2009). For full details of Standards requirements for individual products please refer to Trend Windows & Doors Technical Department.

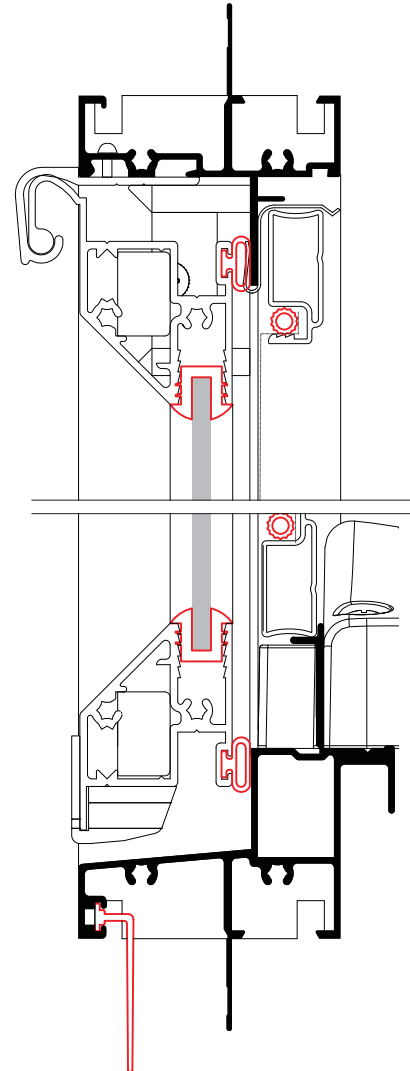

Installation

Xtreme® Aluminium Awning | Building In Detail | **Brick Veneer - 230mm wall**

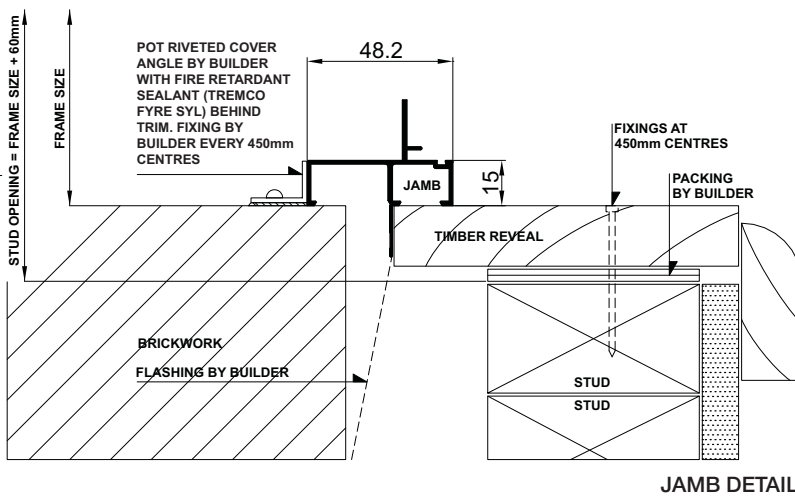
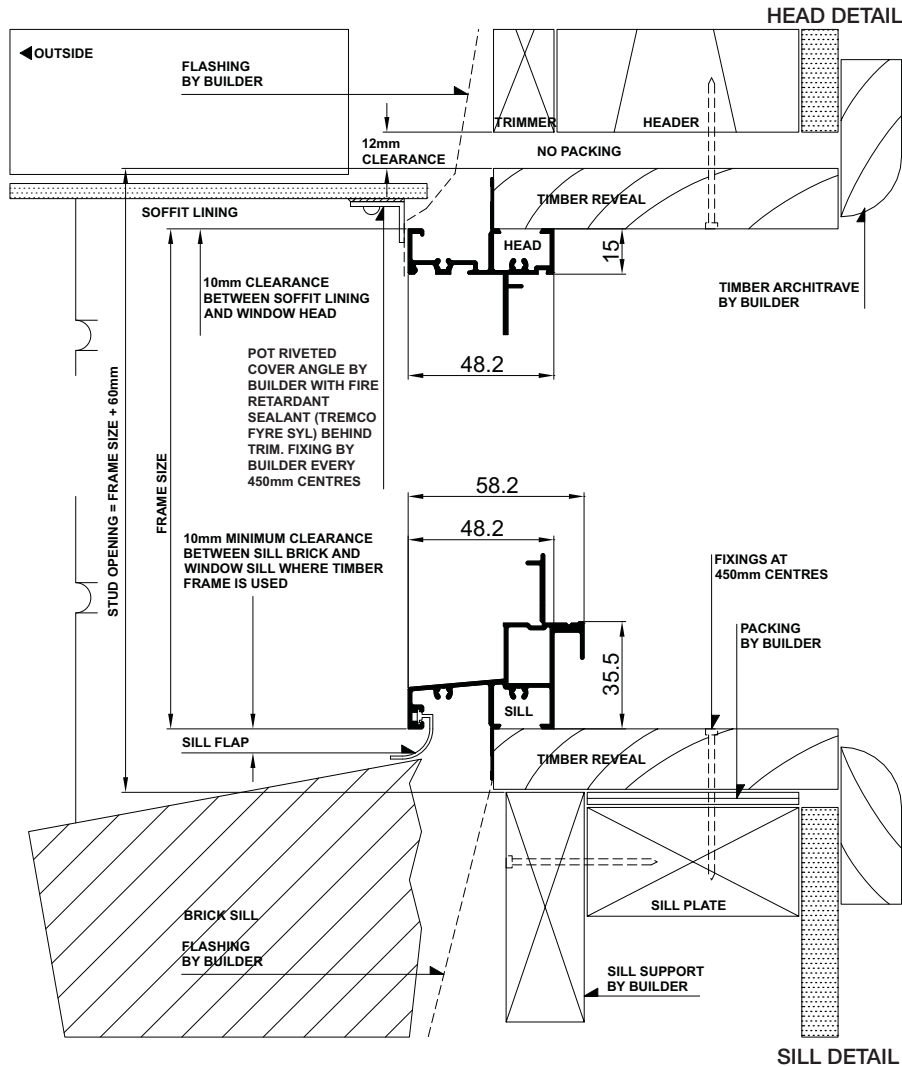

Installation

Xtreme® Aluminium Awning | Building In Detail | **Double Brick - 280mm wall**

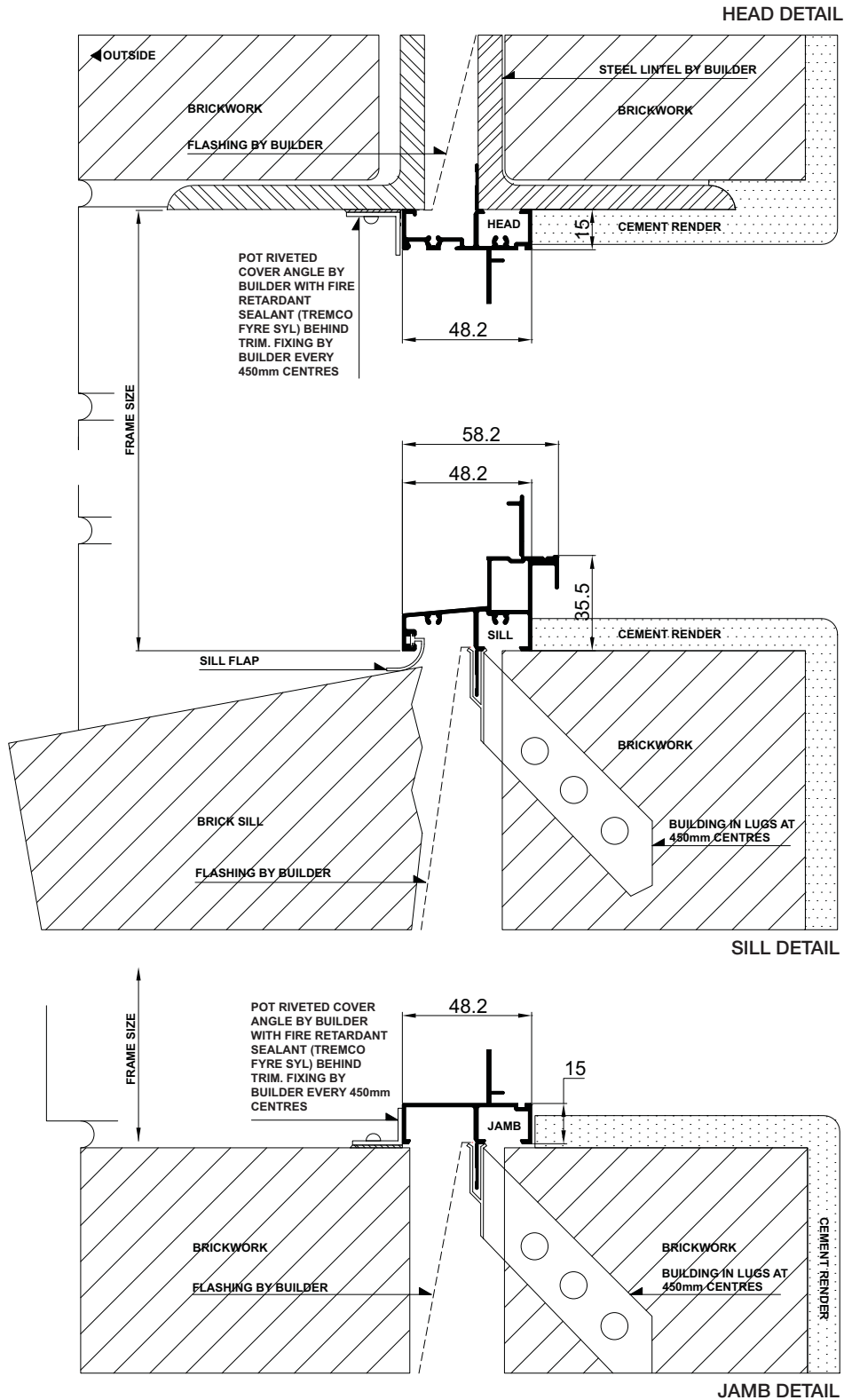

Cross Sectional Views

Xtreme® Aluminium Awning | 48mm | **Standard**

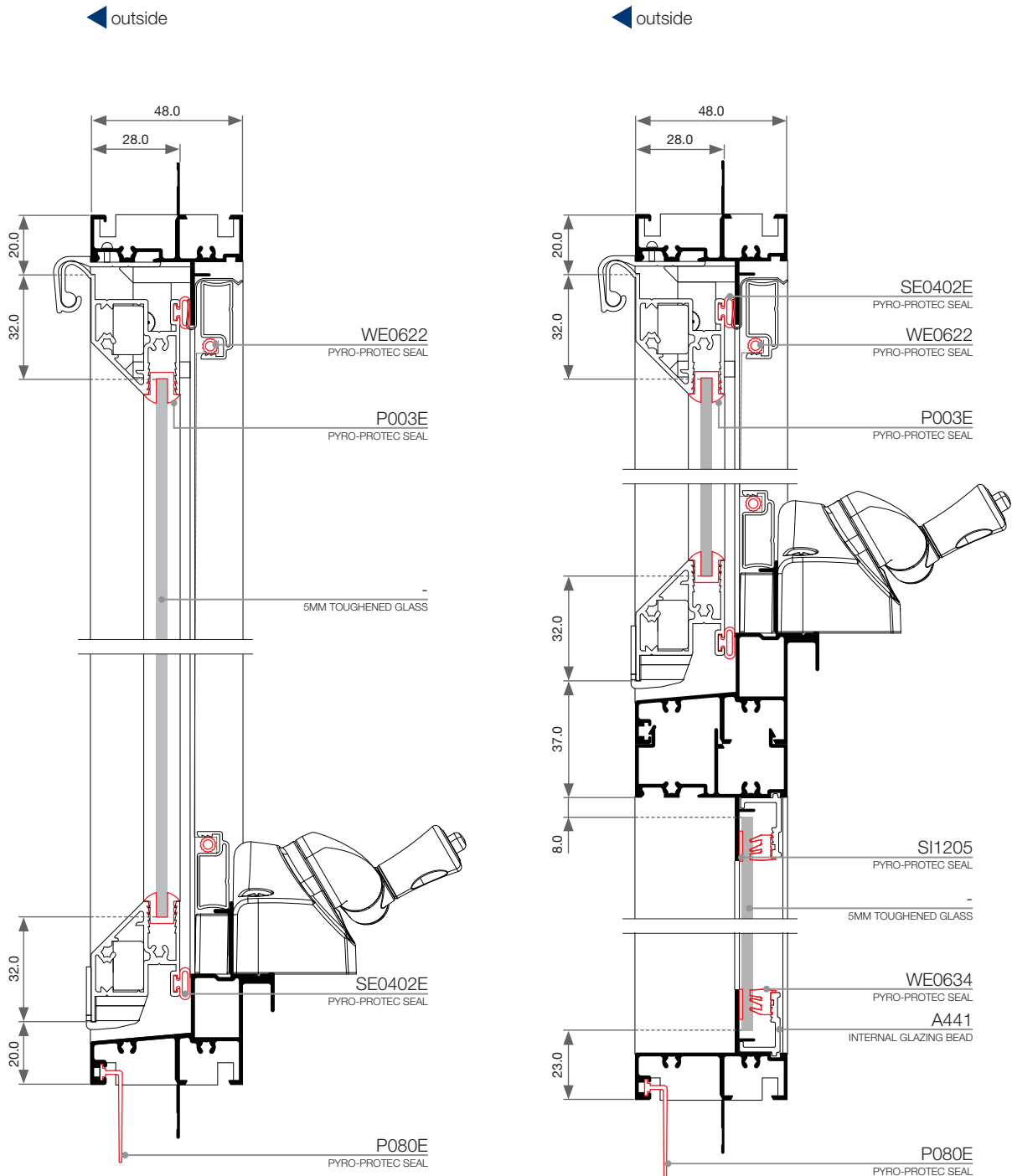

Cross Sectional Views

Xtreme® Aluminium Awning | 48mm | **Standard**

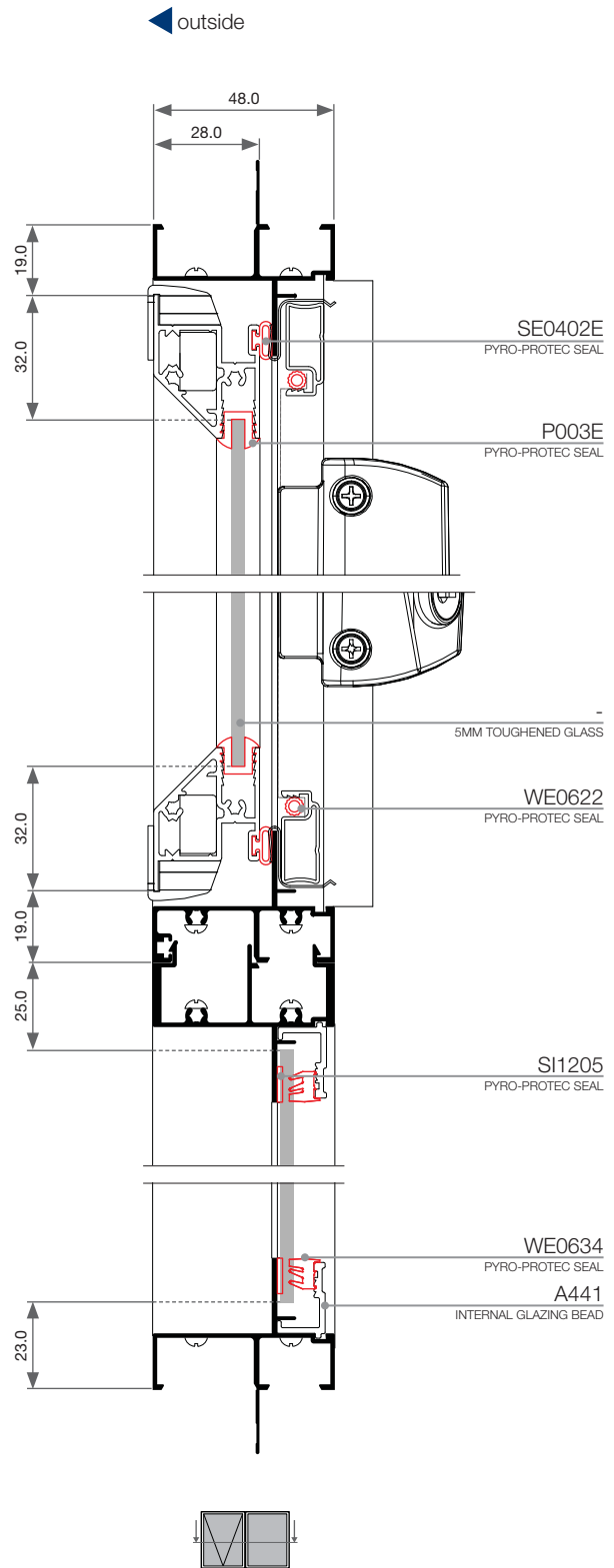
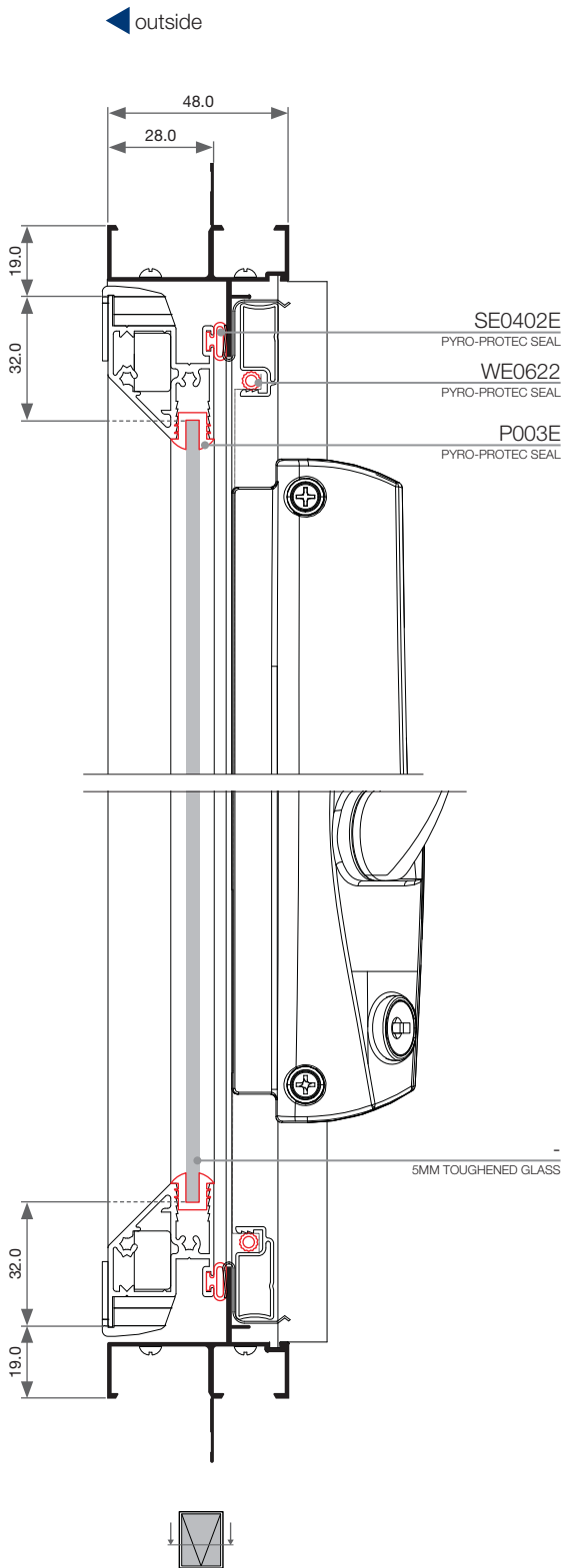

Cross Sectional Views

Xtreme® Aluminium Awning | Sentinel | Sentinel

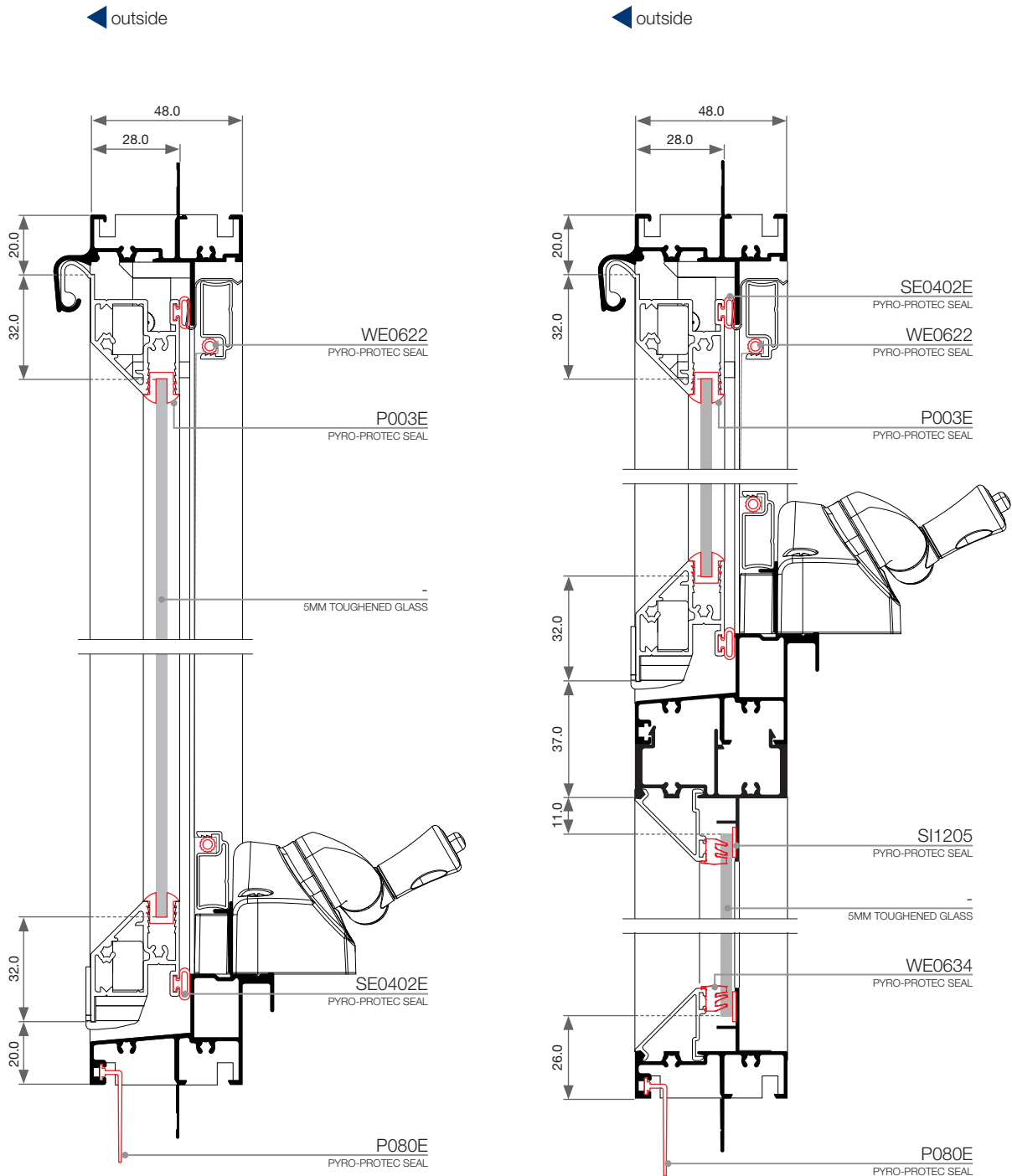

Cross Sectional Views

Xtreme® Aluminium Awning | Sentinel | **Sentinel**

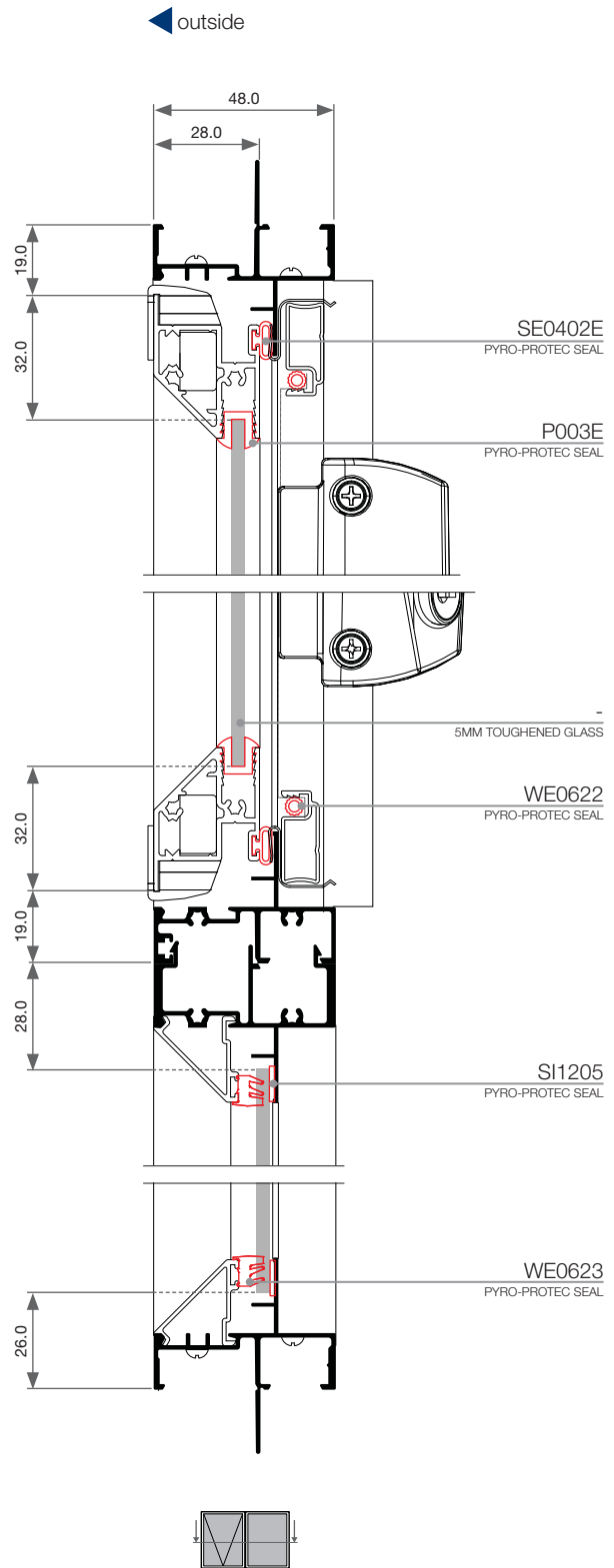
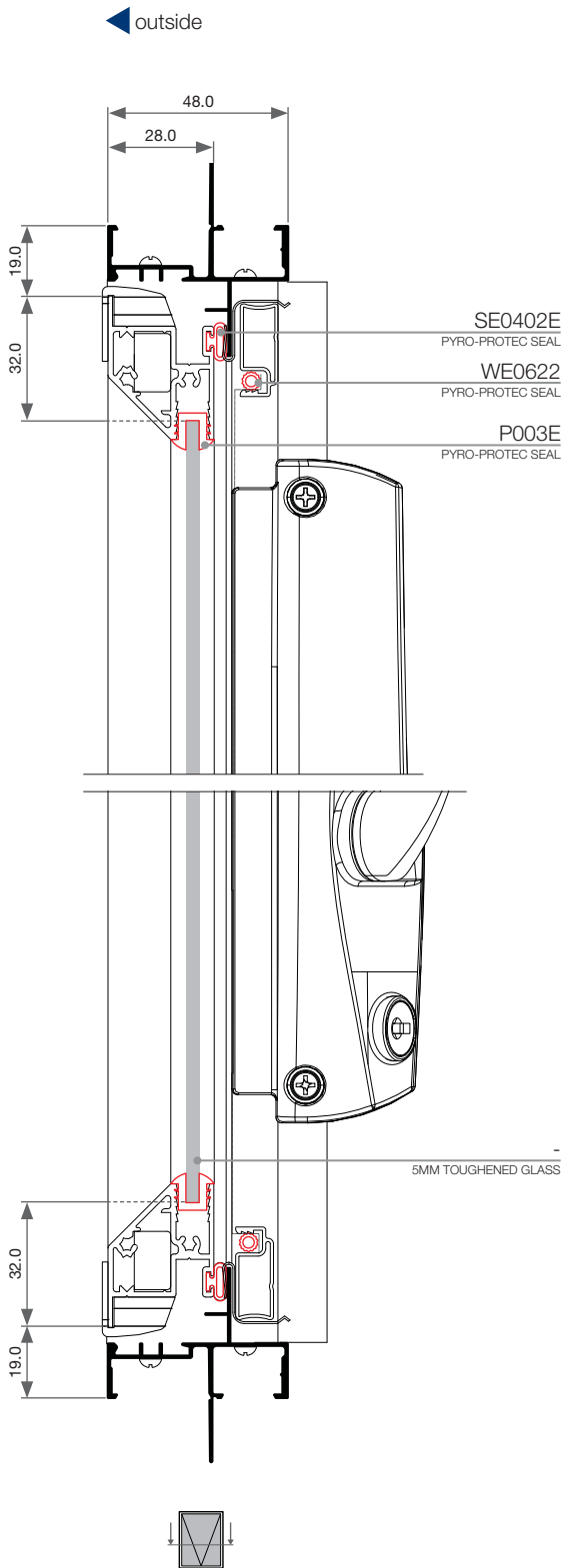

Cross Sectional Views

Xtreme® Aluminium Awning | Thermashield

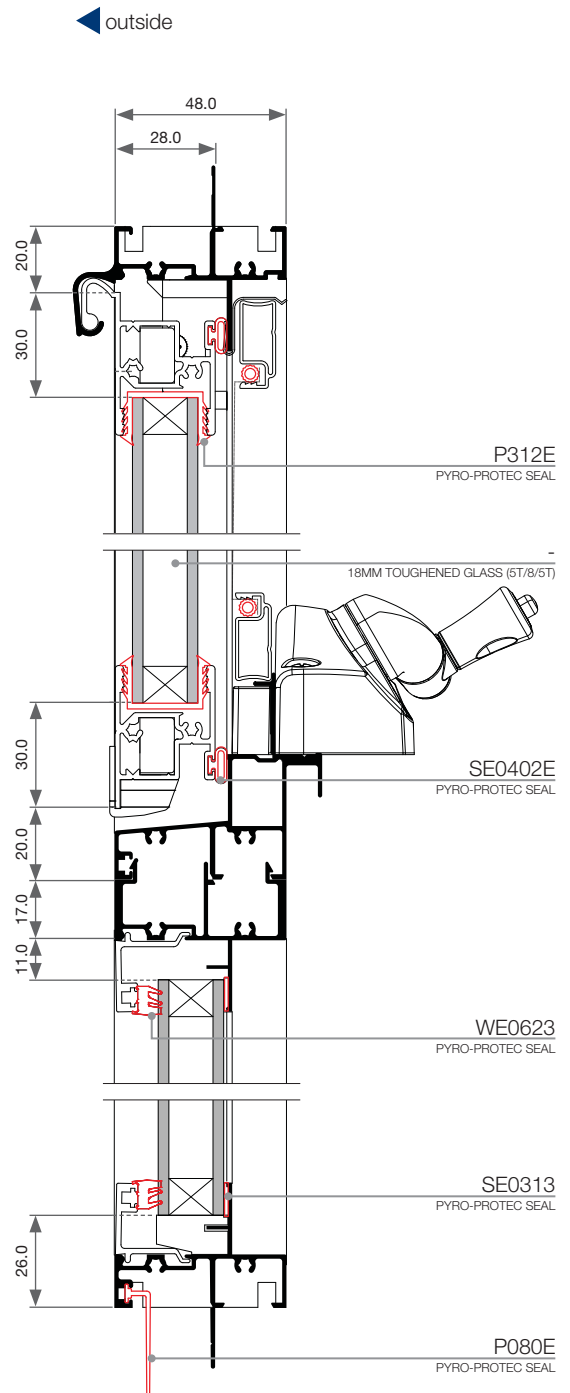
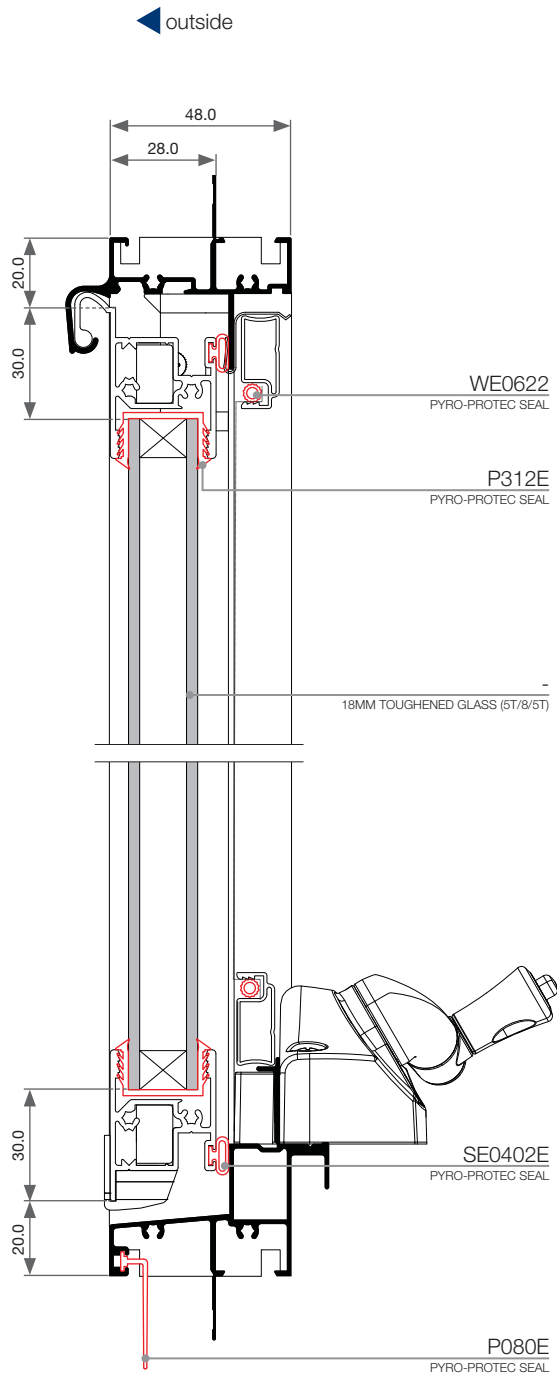

Cross Sectional Views

Xtreme® Aluminium Awning | Thermashield

